

MEET THE 2016 FRAME BUILDING EXPO EXHIBITORS

February 2016 • \$4.50

Rural Builder®

The Business Management Magazine for Rural Contractors
www.ruralbuilder.com

2016 ECONOMIC FORECAST

**Continued
growth
expected**

**Top 10 and Top
eProducts of 2015**
p. 16



PLUS:
New Products
at the Expo!
p. 22

PHOTO FEATURE:
**BUILDING
THE MODERN
BEEF BARN**

P. 62



Rural Builder
2015

TOP 10 PRODUCT

Strength in Post Frame

Since 1951, Plyco has stood by you and by their products. Plyco offers a complete line of entry doors that surpass building codes and customer expectations. At Plyco, we've become the leader by delivering the quality products you and your customers demand.

Build Plyco Strong.

NFBA
FRAME
BUILDING
EXPO
BOOTH #301

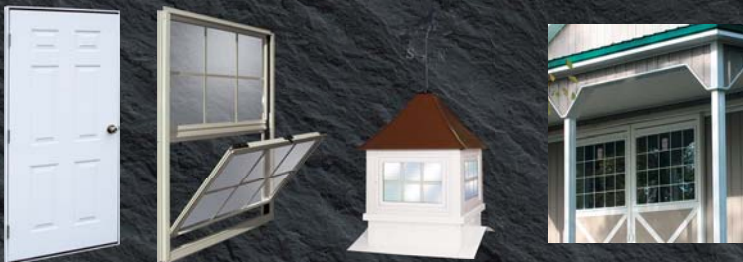

PLYCO
CORPORATION

800.558.5895 • Fax: 800.257.5926 • www.plyco.com • Elkhart Lake, Wis.

Circle Reader Service #313

Rural Builder

Vice President/Group Publisher
Jamie Wilkinson

Publisher/VP Advertising Sales
Dave Davel

Editorial Director
Debbie Bradley

Editor
Sharon Thatcher
sharon.thatcher@fwcommunity.com
715-445-2214, ext. 13644

Advertising Sales
Gary Reichert
gary.reichert@fwcommunity.com
715-445-2214, ext. 13381

Publication Design
Nicole MacMartin

Production Coordinators
Kathy Budsberg
kathy.budsberg@fwcommunity.com
715-445-2214, ext. 13309

Patti Kirchner
patti.kirchner@fwcommunity.com
715-445-2214, ext. 13319

Subscription Services
386-246-3452

Office Phone
715-445-2214

Office Fax
715-445-4087

F+W, A CONTENT + ECOMMERCE COMPANY

Acting CEO, CFO/COO
Jim Ogle

President

Sara Domville

CDO

Chad Phelps

SVP, Mfg. & Production

Phil Graham

VP, Communications

Stacie Berger

SUBSCRIPTION SERVICE

Subscription inquiries, orders and address changes can be made at constructionmag-net.com (click on "Subscribe"). Or by mail: Rural Builder, P.O.Box 421751, Palm Coast, FL 32142-1751. Or call (866)805-1574, International (386)246-3452

Rural Builder (ISSN: 0888-3025) Volume 50 Number 1 is published monthly, except January, April, June and November, by Krause Publications, a division of F+W Media, Inc., 700 E. State Street, Iola, WI 54990-0001. Periodical postage paid at Iola, Wis., and at additional mailing offices. Canadian Agreement Number: 40665675. POSTMASTER: send address changes to Rural Builder, Circulation Department, PO Box 420235, Palm Coast, FL 32142. Copyright 2014 by F+W. Rural Builder and its logo are registered trademarks. Other names and logos referred to or displayed in editorial or advertising content may be trademarked or copyrighted. Rural Builder assumes no responsibility for unsolicited materials sent to it. Publisher and advertisers are not liable for typographical errors that may appear in prices or descriptions in advertisements. Mailed free to rural contractors and their suppliers throughout North America. Others may subscribe: \$29.98 for 1 year, \$55.98 for 2 years, and \$79.98 for 3 years in the U.S.; \$39.98 for 1 year, \$74.98 for 2 years in Canada.



62

FEATURES [FEBRUARY 2016]

6 IN FOCUS: 2016 ECONOMIC FORECAST

- Measuring up the economy
 - Survey results
 - Builders and suppliers size up the market
 - Construction economists share optimism

16 TOP 10 PRODUCTS OF 2015

20 TOP ePRODUCTS OF 2015

29 FRAME BUILDING EXPO EXHIBITORS

62 BUILDING THE MODERN BEEF BARN

22



DEPARTMENTS

Editor's Note.....	3
Index	50
Classifieds	66

MARCH PREVIEW

- Marketing your business through influence
- Product profile: Doors & Door Hardware
- Product feature: Adhesives & Sealants

[ON THE COVER]

Rural builders believe 2016 will balance out to be another good year. Related article beginning on page 6. Photo by Kris Kandler. Cover design by Nicole MacMartin.



E-MAIL THE EDITOR AT
sharon.thatcher@fwcommunity.com

Check our website at
www.ruralbuilder.com



LAM-PLY TRUSS

The Truss That Will Carry The Load

- Spans up to 72 ft.
- Spacings up to 12 ft. on center, depending on the load you desire
- Bird Nesting Control
- Better Ventilation & Visibility
- No Feed Alley Post Obstruction
- Additional Ceiling Height

Starwood Rafter Uses

- Pole Sheds
- Free Stalls
- Pavilion Shelters
- Machinery Storage
- Riding Arenas
- Solar Barns



Starwood Rafters, Inc.
W24141 Starwood Lane
Independence, WI 54747
(715) 985-3117 • 888-525-5878

www.starwoodrafters.com

Circle Reader Service #375

editor's note

It's all about progress

Our February issue is always special because it is the final issue before the annual Frame Building Expo. This year the Expo heads to Indianapolis, and we take a look in these pages at some of the great companies and products that are prepared to be there.

One of those companies is CannonBall:HNP. These days it isn't often when a company gets to celebrate 100 years in business but that is exactly the milestone CannonBall is celebrating. The company began in 1916 catering to the farm market, selling hay forks and wagons. Later it manufactured feed handling equipment and animal confinement stalls. To remain viable, it experienced various transformations throughout the years, but today retains a strong position as a supplier to the post-frame and metal building markets. You've read a lot about them over the years right here in *Rural Builder*. They are in fact one of our oldest *Rural Builder* Gold Key recipients, earning the award for 33 years straight.

Despite its century celebration, CannonBall isn't resting on its laurels. In fact the company is taking the Expo as an occasion to introduce a new line of door track and trolley hardware. Want a sneak peek? Check out the new products at the Expo article starting on page 22.

And while you're at it, check out all the other new and interesting products being unveiled by other companies at this year's event.

Happy birthday, CannonBall! **RB**



Sharon Thatcher,
editor
sharon.thatcher@fwcommunity.com
800-726-9966, ext. 13644

The building suppliers you can trust focus on

BUILDING STRONG RELATIONSHIPS.

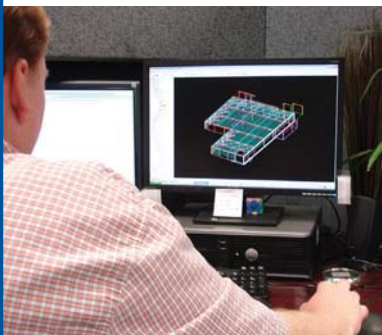

The most solid foundation upon which to build a partnership is trust. That's why, for more than 60 years, Varco Pruden has focused on creating relationships that last.

Our interest is always your best interest. While we offer decades of experience and expertise, constantly educating ourselves on your environment and consumers, we also take pride in our loyalty and value our credibility. You can depend on us to work for you. Because we're not just reliable, we're dedicated. And we never compete against our builder partners.

We offer superior products and service, including:

- ◆ Unrivaled quality
- ◆ Cutting-edge technology and innovation
- ◆ Unequaled marketing tools and resources
- ◆ A wide array of products
- ◆ Experienced project management and field support

Contact Varco Pruden today. Let us show you how, together, we can add value to your business and your reputation.



BECOME AN AUTHORIZED VARCO PRUDEN BUILDER TODAY.

Call 1-866-538-0012 or log on to www.VP.com/ad/RBM.

Circle Reader Service #301

In-stock for when you need it...
YESTERDAY!

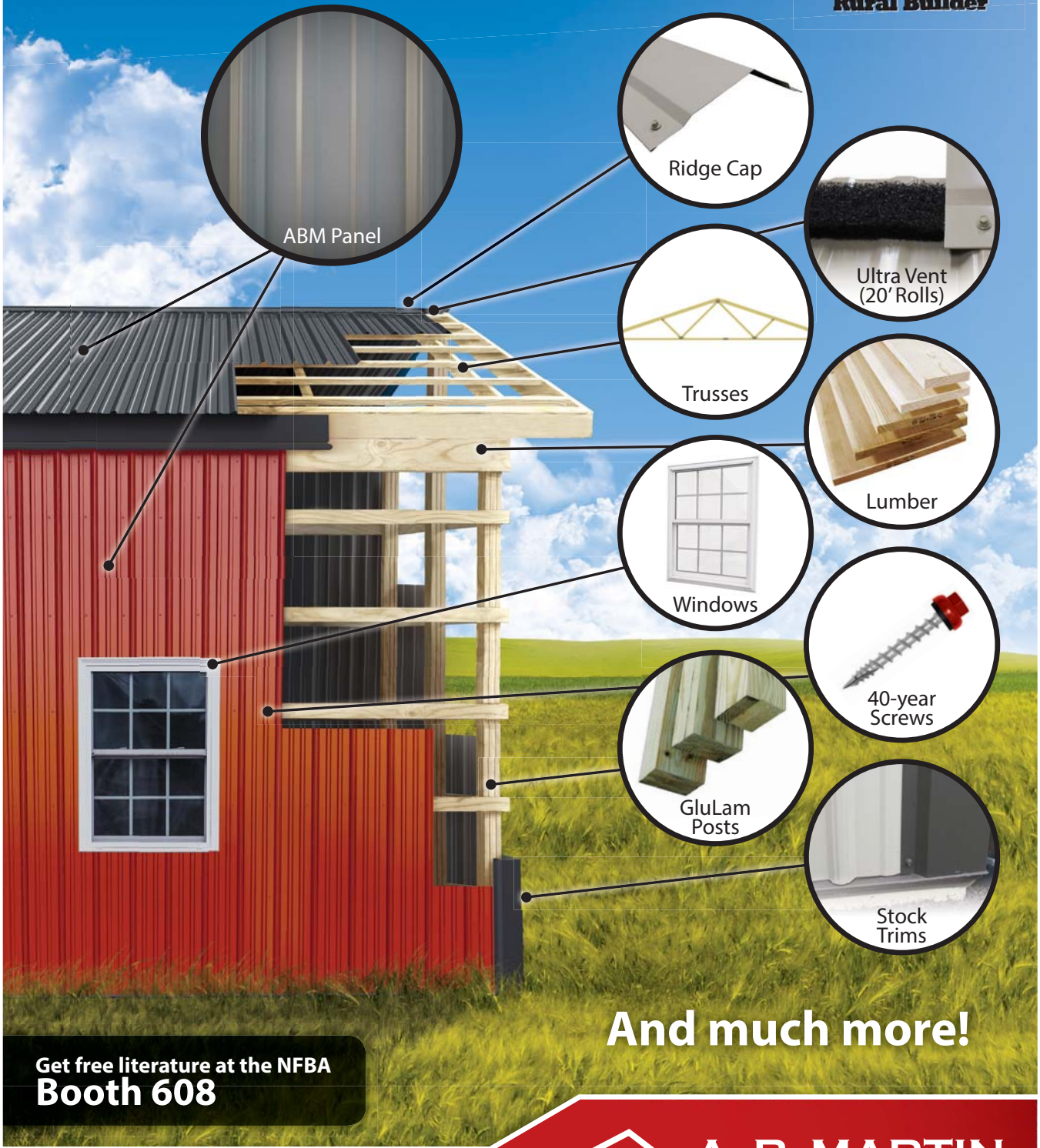

ABM Panel



Ridge Cap



Ultra Vent
(20' Rolls)

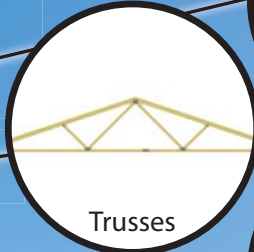

Trusses



Lumber



Windows



40-year
Screws



GluLam
Posts



Stock
Trims

And much more!

Get free literature at the NFBA
Booth 608

82 Garden Spot Rd. | Ephrata, PA 17522 | 717-445-6885
35 Ridge Rd. | Newville, PA 17241 | 717-776-5951
www.abmartin.net



A. B. MARTIN
ROOFING SUPPLY, LLC

Roofing & Siding • Hardware • Lumber

2016 Economic Forecast

Builders and suppliers looking forward to more steady growth

IT'S BEEN A LONG UPHILL CLIMB TO FULL ECONOMIC RECOVERY FOR THE CONSTRUCTION INDUSTRY BUT RURAL BUILDER HAS FOUND AMPLE REASONS FOR CONTINUED OPTIMISM. In our annual look into the state of the industry, we found plenty of evidence that is signaling good times ahead. It starts with the results of our annual survey. We asked builders and suppliers to tell us how well they were doing in their own businesses. **RB**

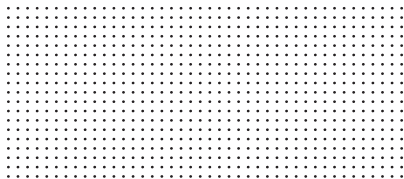

SURVEY RESULTS

EXPECTED CONTRACT VOLUME CHANGE 2016 VS. 2015

- Significant increase expected: 10%
- Moderate increase expected: 30%
- Expect to stay about the same: 50%
- Significant decrease expected: 5%
- Moderate decrease expected: 5%

EMPLOYMENT OUTLOOK FOR 2016

- Expect to hire: 30%
- Likely to remain the same: 60%
- Expect to reduce: 10%

BACKLOG AS OF MID-DECEMBER 2015

- Contracts lined up through 2016: 10%
- Contracts lined up for 6 months: 30%
- Currently working on a project and expect to stay busy all year: 40%
- Working project to project but are optimistic: 10%
- Currently working on a project with nothing lined up: 5%
- Currently have no contracts: 5%

LEVEL OF OPTIMISM ABOUT CONSTRUCTION

- Very optimistic: 30%
- Cautiously optimistic: 35%
- Neutral: 25%
- Somewhat pessimistic: 10%
- Very pessimistic: 0%

AREAS OF GROWTH EXPECTED IN 2016

- Single-family housing: 25%
- Multi-family housing: 15%
- Commercial building: 45%
- Agricultural building: 35%
- Institutional building: 0%
- Manufacturing building: 15%
- Public works: 20%
- None of the above: 20%

AREAS OF DECLINE EXPECTED IN 2016

- Single-family housing: 20%
- Multi-family housing: 15%
- Commercial building: 10%
- Agricultural building: 50%
- Institutional building: 15%
- Manufacturing building: 15%
- Public works: 10%
- None of the above: 0%

ROUND TRACK

YOU'RE ON THE RIGHT TRACK WITH **WESTERN**

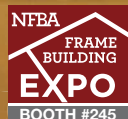

600-lb. capacity, smooth, easy gliding round track. Self-cleaning design, corrosive resistant 14 gauge galvanized construction.

(800) 553-5142 www.westernproductsinc.com

ALSO FROM WESTERN: 1 1/2" + 3 1/2" SLIDING ALUMINUM DOOR FRAMES

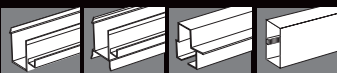

WESTERN PRODUCTS OF INDIANA

Circle Reader Service #374

Visit us
MARCH 8-11

NFBA
FRAME
BUILDING
EXPO

BOOTH #227

Indianapolis, IN

NEW FOR 2016

RED ROLLERS

Ask about new Red Roller availability
in our most popular Delrin Trolley
model (Stock Code 713999)!



800-766-2825 • Beloit, WI
www.cnbhnp.com

Circle Reader Service #386

Measuring up the economy

Builders and suppliers size up the market

TO GET A READ ON WHERE THINGS ARE HEADED through the remainder of 2016, we returned to some of the same builders and suppliers who provided us their feedback last year. In their words, here is how 2015 stacked up and where they see the market heading through 2016.

■ RICK ANDERSEN, ANDERSEN CONSTRUCTION, STERLING, ILLINOIS

Farm construction outlook for 2016: "I attended the [Greater Peoria Farm Show] the first week of December and I actually thought it was a little better than last year. I don't think farmers are doing much better than they were a year ago but I think a lot of them are doing repairs, a lot of them are talking future projects. There will be some projects on the farm [in 2016], probably about the same [as 2015]."

"With ag, there's just not going to be much done until commodities go back up and it might take awhile. What [farmers] are getting for their product is half of what they were getting four, five years ago, and their input costs are two or three times greater than what they were."

Looking back on 2015: "The year turned out about what I expected. I was looking back at what I told you a year ago, and I said 2014 was a little above average and 2015 was also a little above average."

"The ag market was down so we had more commercial buildings and more country suburban hobby shops."

"We had plenty of work. We had steady work all the way through. I had a lull at the end of the summer and at the start of the fall, but I'm getting more calls for quotes now than I have in a long time."

Backlog: Andersen said he had a backlog of about five buildings going into 2016. He said: "Depending on the weather, that will give us a good start into the spring, and we have some repair jobs going again."

Interest rates: "I've asked some people about that and nobody thinks that's a big deal yet. If we get two or three rises, then it might be."

Material prices: "Our cost of steel and lumber for 2015 actually stayed lower than normal so that helped us out. If business stays good, I expect [prices] to tick up a little bit, but I don't expect it to be a big thing."



Builders and suppliers expect the industry to keep its upward momentum in 2016.

Biggest concern: Health insurance costs. "What I've heard from several people ... is the high cost and how much their health service premiums and deductibles have gone up, and I think that might be a hidden [problem]. Fuel savings has helped all of us, but it seems like nobody has any extra money because they're paying more on their health care costs and deductibles."

Andersen explained that he was on his wife's health insurance plan until she retired from teaching three years ago. "When I had to get my own, I thought it was fairly reasonable and the deductibles were reasonable. Then when Obama Care kicked in, I got to keep my coverage, thank goodness it wasn't going to cost much more, but the deductibles were twice as much. Now I just got a letter the other day that in September it's going to go up and I got a heads up that, in four years time my monthly premium will have gone up \$1,000 for this plain policy. That's per month. So it's huge."

Multiple colors, profiles and wood accents make an outstanding commercial presentation.



Born in the lab. Verified by the sun.

APPLIED SCIENCE

Two coatings: one PVDF one polyester and both endorsed by Mother Nature and Father Time.

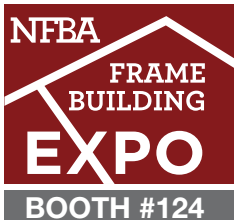

DURA COAT PRODUCTS, INC.

RIVERSIDE, CALIFORNIA
(951) 341-6500

HUNTSVILLE, ALABAMA
(256) 350-4300

www.duracoatproducts.com

Circle Reader Service #581



DURA COAT PRODUCTS ORIGINATED ALMOST THREE DECADES AGO IN A SMALL LAB with one scientist determined to develop a coil coating that could outperform all the others. A harder coating that would be scratch- and fade resistant, flexible and green, that would be applicator friendly and durable. Even today, those are ambitious, progressive goals. But science, innovation and determination produced exceptional results.

Durapon 70

DURAPON 70™ PVDF outperforms all the old standards. Harder and more flexible than other premium PVDF coatings, it is exceptionally resistant to installation scratching, scuffing, marring, staining and transit abrasion. It is also tough against the elements with outstanding resistance to UV rays. With only the highest quality cool roof pigments, it reduces the carbon footprint and lessens the heat island effect. It also has exceptional color retention and resistance to chalking and chemicals making it ideal for architectural projects, monumental buildings and high-end residences. It complies with Energy Star, LEED 29 and Cool Roof standards.

XT-40S Ceranamel CERANAMEL™ XT-40S coil coating provides excellent long-term exterior performance. It has a porcelain-type finish that is harder and more abrasion resistant than competitive SMP coatings. Formulated from a proprietary polymer resin, it is hard and physically inert to resist chalking, fading and weathering. With high-quality cool pigmentation, it delivers long term color and gloss retention. Its weathering characteristics make it the cost effective choice for light commercial, residential, tiles and shingles and agricultural applications.

To learn more about these exceptional coatings, call 951-341-6500, 256-350-4300 or email info@duracoatproducts.com.



BY SHARON THATCHER

■ **JASON BLENKER,**

BLENKER COMPANIES (CONSTRUCTION SERVICE AND SUPPLY),
AMHERST, WISCONSIN

Looking back on 2015: "We had a noticeable increase in single-family activity, and multi-family really held its own in terms of our total revenues. I think it was pretty much on par with our expectations with what we thought the market was going to do."

Lending: "We're seeing more of those entry-level projects. Buyers are getting access a little easier to that money. From the people I'm talking to, the mortgage people are looking to get back into residential lending."

Interest rates: Blenker didn't express much concern over an impending interest rate increase. "We didn't see any change when talk was to increase interest rates," he said.

A small increase was finally implemented by the Federal Reserve in mid-December to a relatively minor reaction.

2016 residential: "I think the market is going to continue to improve, same as last year. Single family [housing] is slowly going to continue to get better. Our multi-family business is going to stay pretty consistent based on the backlog we have and the people we're talking to for spring starts. Overall, it's going to be very similar to 2015 with continued increases in residential activity. I don't think it's going to be double-digit growth opportunities but I think there's going to be enough work out there for everybody."

2016 commercial: "Locally a lot of things are happening in the metro markets, not a lot in the manufacturing sectors, but technology and service industries are hiring and expanding so that's a good thing."

Labor: "For builders and contractors the thing is finding skilled labor, finding people to replace a somewhat aging workforce. An increase in demand is going to put restraints on finding good people to fill the void."

Lumber prices: Construction in the Midwest relies heavily on Canadian lumber, Blenker noted, adding: "Lumber is going to be an interesting one to watch. We've had relatively low lumber prices but I think there's going to be some things going on with Canadian timber and some of their exports. If I have any concern it's for stable lumber prices. I've got a sneaking suspicion they're going to increase come spring."

"[Canada is] not getting as much export business to China and some of the other foreign markets as they were three or four years ago with the slow down in China, so they don't have as many outlets for their timber. I think they're going to find ways to slow production to drive prices and margins up to the level they want to operate."

Presidential election: "It's interesting, the election hasn't really come up in any conversations we've had, as far as concerns on what's going to happen."

Outlook for 2016: "Quite honestly, I don't see a lot of fears or objections to what the economy is doing. I think the general consumer is happy with the fact that gas prices are down compared to what they've been in the past four or five years. Consumers are happy and they're spending more money and

I think its going to trickle into every other industry. Car sales are at all-time highs, which usually translates then into housing sales improving. After people buy their new car, a few years later ... they save a little more money to buy a new house. Overall, my outlook is very optimistic."

■ **WAYNE TROYER,**

PAINT VALLEY EQUIPMENT/ACU-FORM, MILLERSBURG, OHIO

Looking back on 2015: "We ended up having a great year, shipping more [roll forming] machines than we've ever shipped."

Troyer said there was a bit of a slow-down in the fall, but by early December business was "gang busters again."

The end of the year is traditionally busy for them. "People are seeing that it's time for taxes and they'd better order machines," he said.

In 2015 the company thought it was well prepared for the year-end blitz. "We normally build stock for the end of the year because there's always people wanting to spend money at the end of the year. Well this year we didn't make it that far. We've been building machines to fill orders as fast as we can go."

Outlook for 2016: "Going ahead it looks great ... even with the election year, I see it being a great year."

"We have quite a few orders ahead right now (early December)," he said. "With our ag panel lines, our machine orders are being processed to get done by the end of March. We've got a backlog."

Troyer believes his customer base won't change much. It currently varies from contractors forming metal for their own projects to small businesses that are exclusively in the roll-forming business. The latter were once re-sellers of panels who purchased pre-formed product from a number of companies. They have now made the switch to buying steel coil, roll forming it and thus selling their own panels. "And that goes to the point of the market where everybody wants their product now," Troyer said.

Challenges: "With a lot of people, their main concern right now is, with roll formers going in everywhere, they're afraid the market will get flooded with roll formers. Then again, builders are seeing that everyone wants their product now and they say, 'we can afford to put a roll former in. We can buy that roll former, roll our own metal and that's enough savings for us to pay the machine off.'"

The majority of Paint Valley's customers are already in business and are confident enough in the market to purchase an upgrade from startup machines. "In the last year, like 75 percent of our roll formers went to customers that already had roll formers but they were used ones and now they're replacing them with ours."

Material costs: "Steel prices are coming down some. They're staying pretty steady. As far as the coil material, I see it dropping some. But ... when prices went up, [steel companies] tried to hold their prices so now they are not dropping down right away, they're trying to hold the market steady." **RB**

DYNAMIC FASTENER

Rural Builder
2015



Everything for the Metal Builder & Roofer™



FREE 132 Page Full Color Tool & Fastener Hand Guide provides prices, engineering data & details product offering.

DYNAMIC FASTENER is specifically geared to handle the needs of the Rural Building Contractor. We provide in-house custom color painting of screws and rivets with just a one or two day (days, *NOT* weeks) lead time. **TENS OF THOUSANDS** of power tools are stocked and sold at the lowest prices. Highest quality, top name brand fasteners are stocked and sold at the lowest prices. Same day shipment on orders received by 4:00 p.m. CST. We are a supplier to the largest metal building manufacturers.

We want to be **YOUR** source for screws, anchors, flashings, **DYNA-GUARD™** snow retention system, safety equipment, hand tools, power tools and accessories.

7 warehouses to serve your construction needs for tools and fasteners

(MAIN OFFICE)
Kansas City • Chicago • Houston • Las Vegas • Memphis • St. Louis • St. Paul

CALL 800-821-5448 or FAX 800-844-1199

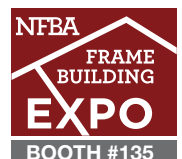

Call for your Free Full Color 132 Pg. Hand Guide. Better yet, call us for your next tool or fastener requirement. Discover for yourself why your peers enjoy doing business with our company!

Construction economists share optimism

ECONOMISTS IN THE CONSTRUCTION INDUSTRY keep a daily read on the market. They share a general optimism these days for the U.S. economy, but also note some areas of concern. In their words, here is how they see 2015 stacked up and where they see the market heading through 2016.

■ ANIRBAN BASU,

CHIEF ECONOMIST, ASSOCIATED BUILDERS AND CONTRACTORS

Forecast for 2016: "It should shape up to be a solid year for nonresidential construction spending. I'm expecting 7.4 percent.

"Generally speaking this has been a good time for contractors, they've gotten busy and there is some indication that their margins are beginning to widen.

"The all time peak for non-residential construction in our country occurred in October of 2008. But between October 2008 and January 2011, nonresidential spending in our country dipped 29.6 percent. It's important to note that a depression is defined as a 10 percent reduction in economic activity. This industry suffered the equivalent of three depressions ... Through August of 2015 the industry was about 90 percent recovered.

"We're not back yet. Some segments of nonresidential construction—and there are 16 of them—are much better. Nonresidential spending, year over year, is up 12.4 percent, manufacturing-related spending is up 41.3 percent largely due to the rebound of the U.S. auto sector. New car sales are off the charts, better than pre-recession levels, and that should keep that segment of the economy humming.

"Lodging is up nearly 32 percent on a year-over-year basis. The good news is that travel is up, leisure is up, hotel occupancy rates are up, so lodging construction rates are up.

"The public sector is coming back. State and local government finances are continuing to improve and so we are seeing some improvement in public funding...

One of the real wild cards is power. With natural gas prices so low ... we might see certain projects that were postponed, come back on line. Of course that would be very positive.

Some of the states hit hardest by the foreclosure crisis were California, Florida, Arizona and Nevada, and they have been among the leaders recently in terms of adding construction jobs. The housing market has stabilized, the foreclosure

crisis is largely in the rearview mirror. States like Maryland, Pennsylvania and Virginia, these are states that have found new funding mechanism to finance infrastructure investment.

Interest rates: "I think interest rates will remain at near historic lows even if they do rise a bit over the next couple years. In fact the four segments that really drive the economy forward—consumer spending, auto, residential and nonresidential construction—are largely oriented around low interest rates and the Federal Reserve knows it."

■ KERMIT BAKER,

CHIEF ECONOMIST, AMERICAN INSTITUTE OF ARCHITECTS

Home improvement activity: "It's a \$324 billion market ... We think we're going to hit that level this year. It looks like it's going to match its all-time high. It looks like its going to be back to its 2007 level without any inflation adjustments. It fell about 15 percent during the downturn. Most of that decline was in the upper-end projects: kitchen and bath remodels, room additions and things like that. A large segment of this industry is in the replacement area—roofing, siding, windows, electrical, plumbing, HV/AC, interior replacements—they can be a little more stable.

"The current market is a little more balanced, a little less reliant on upper-end projects, so that should provide a little bit of stability moving forward."

Cash is still king: "We like to say that cash is still king in the home improvement market. It relies heavily on cash transactions. Piper Jaffray, a Wall Street firm, has been conducting home improvement surveys the last three years, and one question for households planning to undertake large home improvement is how they're planning to finance that project. Some households are planning to use multiple sources of financing, but according to these surveys, it's an industry that has been characterized by its heavy reliance on cash financing. Even in the credit-focused world today, this hasn't changed significantly. Owners are somewhat less likely to rely on cash,



Fight Condensation Without Insulation

A Necessity for Any Steel Roofed Building That is Not Climate Controlled.

- Post Frame/agricultural buildings
- Steel buildings
- Self-storage
- Workshops/unattached garages
- Open-walled structures
- Carports, truck ports & RV storage



DripStop Stops the Dripping from Condensation.

When condensation occurs, moisture gets stored in the specially designed pockets of the DripStop membrane.

DripStop is applied at the time of roll forming

- Arrives on-site already on roof panels
- Helps fight corrosion in livestock confinement
- Significantly reduces construction time
- Saves money

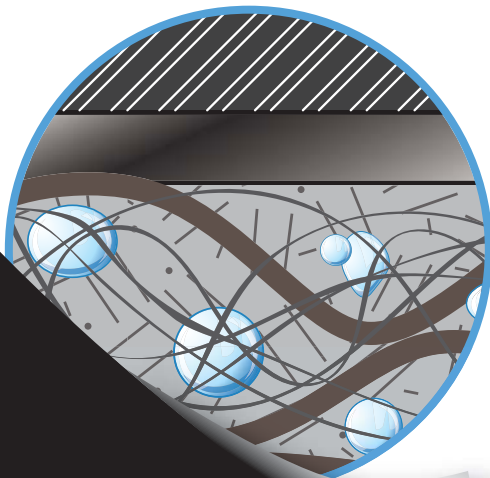

When metal roofs are applied directly over shingles,

STEEL SHIELD

Protects the Metal and Your Investment.



Ask for it from your preferred steel panel supplier

Visit our website at www.dripstop.com

or call us at: 1-(937) 660-6646

Circle Reader Service #384

BY SHARON THATCHER

but it doesn't revolve around borrowing or doesn't rely on borrowing to any significant degree."

Current construction levels and how they compare historically over the past 35: "We've averaged just about 1.3 billion square feet of nonresidential building construction per year. It varies per year. It's a very cyclical area of the economy, but generally we see several years of above average construction level followed by a few years of below average. And we've seen below average since 2008 so it certainly seems like we have some pent-up demand in this market that should generate some growth moving forward."

DAVID CROWE,

CHIEF ECONOMIST,
NATIONAL ASSOCIATION OF HOME BUILDERS

New Home Construction: "Demand for new homes is really driven by two



Alpine Distribution, a proven established metal coil distributor to roll-forming companies, is excited to announce that we are expanding our distribution to points in the Midwest & Southeast!

Alpine Distribution Delivers

- Competitively priced domestic quality steel
- Consistent product
- Reliable service
- Caring knowledgeable people
- Experience in custom steel programs and product specifications
- Offering bare CT, acrylic coated & painted galvalume/galvanized coil in any paint quality

There is a difference in suppliers, find out why Alpine Distribution is growing!

Proudly Offering U.S. Made Steel



**For inquiries please contact
Steve Swaney (314) 757-2733
Toll-free (888) 219-8451
steves@alpinew.com**

Circle Reader Service #481



THE AIA ARCHITECTURE BILLINGS INDEX

"Although it remains quite volatile, the ABI has been seeing its strongest scores since the [economic] downturn, suggesting we should see healthy growth in the quarters and years ahead of us."

AIA CONSENSUS FORECAST

"The number we're seeing from this panel is consistent with the ABI ... We're expecting high single-digit growth in construction; double digit growth on the commercial side; low single-digit growth on the institution side; then [in 2016], a big flattening out on the commercial side as we go into the latter part of the cycle on the commercial side, but institutional just beginning to build momentum."

— KERMIT BAKER, CHIEF ECONOMIST, AMERICAN INSTITUTE OF ARCHITECTS

things: employment and people (growing demographics). On the demand side, what we have is certainly improving employment. A real simple example, we now have more people than ever before working. At the peak of the last boom, we had 138 million people working. We're now at 142 million people working. So we've recovered all those lost jobs but we're not up to where we need to be. It's why the employment rate is not necessarily a good guide to the real level of employment because we've gotten people who've fallen out of the workforce altogether.

"There's a strong correlation between employment and single-family home permits. Markets like Austin and San Jose have had very strong employment markets, strong [additions] to total employed people and as a result they've had some of the highest increases in single-family home construction ... Places like Pittsburgh, heavily industrialized, are not really moving very strongly in either direction.

"There is one caveat in employment that is a little concerning and that is why we're seeing a stronger growth in the multi-family arena rather than the single-family arena and that's because the jobs that are being created tend not to be as high pay as in past recoveries. In the service-producing sector we've increased by 10 million jobs ... whereas jobs in the goods-producing sector, which tend to have higher pay scales, haven't come back to where they were

at the peak. So that is a slight downer to the otherwise decent job growth."

Forecast for 2016: "I think we'll have a good economy. Even with its mild or mediocre growth rate, [the U.S. economy] is still better than most other countries, so we've attracted a lot of foreign capital and that has kept our mortgage rates low.

"The biggest reason behind the lack of home buying has been the availability of the mortgage not the price of the mortgage, and that is being addressed, not very rapidly, but we have seen some modifications to some of the severe underwriting restrictions that have brought more people into the market and I think that will continue."

Looking back on 2015: "If you look at how we were compared to the last normal period, the early 2000s, we were producing a little over 1.3 million single-family housing starts a year. If that's a reasonable comparison, we're 53 percent of the way back. So it's still a long way to go.

"I think the increase in the single-family side will come from pent-up demand of existing homeowners and some first-time home buyers, so we will start seeing some of those renters, particularly the older millennials that have been established in their own apartment homes, start to peel off and become homeowners.

"The multi-family sector is a totally different story, we're all the way back." **RB**



BUILT FOR POST FRAME

THE INDUSTRY'S LEADING MANUFACTURER AND SUPPLIER OF POST FRAME BUILDING ACCESSORIES

Since 1985 MWI Components has been manufacturing quality products for the Post Frame Industry, right here in Northwest Iowa.



COME SEE US AT BOOTH #321 AT THE NATIONAL FRAME BUILDING EXPO

MARCH 9 - 11 IN INDIANAPOLIS, INDIANA

• WE LOOK FORWARD TO VISITING WITH YOU •

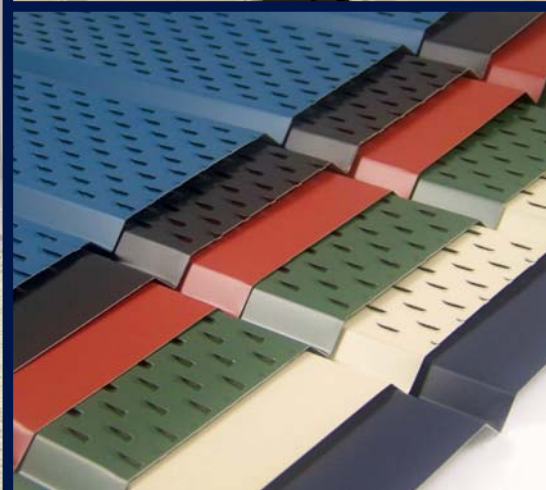
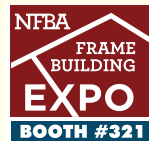

**MWI Components • www.mwicomponents.com
1015 32nd Ave West • Spencer, Iowa 51301
Ph: 800-360-6467 - Ext 5 • FAX: 800-361-3452**



Circle Reader Service #308



TOP 10 PRODUCTS OF 2015

PRODUCTS WORTH A SECOND LOOK. Throughout the year, readers of *Rural Builder* play an important role in helping to determine what products make our annual Top 10 list. Every issue, when readers want to learn more about a certain product or company, they just circle the corresponding numbers found with each listing on the Reader Service Cards and send them back. Tracking responses shows what types of products are sparking the most interest.

So, the results have been tallied and here is the Top 10 Products of 2015. In case you missed them the first time around, take a look now. **RB**



PLYCO – GENERAL LINE OF POST-FRAME PRODUCTS



Plyco Corporation is often in our Top 10 list, and for good reasons. Builders have come to depend on the company's full line of products to help meet today's demanding building codes. From agriculture and outbuildings, to commercial fire- and wind-rated, to residential, Plyco can supply quality products to fit your needs. Plyco track, SDR, ridge vents, cupolas, slide doors, Dutch doors, Champion doors, Equus products and Ply-Foil help make your life easier with one-stop shopping. In addition, East Coast Fasteners can fill your fastener requirements for a complete package. **Circle 102**

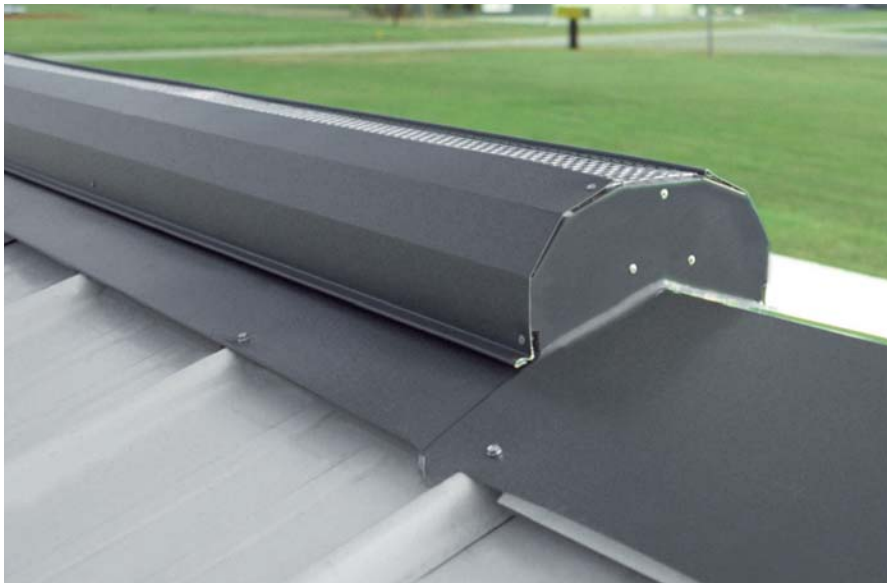

MWI COMPONENTS – RIDGE-VENTS AND UNI-VENT



Proper ventilation is one of the most important elements of a building and getting it right can mean healthier buildings and healthier occupants. MWI is leading the industry in natural ventilation. Not only does MWI supply Uni-Vent II and Uni-Vent III to ventilate with a ridge cap, but it also manufactures five profiles of Ridg-Vents to provide outstanding ventilation. Ridg-Vents exhaust air out of an attic or whole building. When used in conjunction with vented soffit, Ridg-Vents provide superior ventilation. Customers also have the option of choosing a fiberglass diverter on some models to allow natural light into a structure. With more than 100 colors to choose from, MWI can match most manufacturers' steel colors. **Circle 101**



DYNAMIC FASTENER – FEIN NO. BLK. 1.3 CS NIBBLER



Dynamic Fastener offers the Fein No. BLK 1.3CS, the fastest, most maneuverable and well-balanced nibbler in the industry. It replaces the ever-popular Fein RSS 636-2. The BLK 1.3CS cuts flat or corrugated sheet metal up to 18 gauges thick. Cutting speed is a snappy 7.5 feet per minute. Its rotating punch system increases punch life by 30 percent. Eight die locations allow cutting direction to be adjusted in 45-degree increments without tools. No tools are needed to change punch or die. There is no set screw on the die, instead unscrew by hand the collar around the die. **Circle 103**

We stock
100% Made
in the USA

Specialty Painted Nails!

- Color matched nails save time and labor on prefinished jobs
- Engineered for both face and blind nailing applications
- Available in double hot dip galvanized coils, collated sticks and hand drive
- Hammer caps included with each 5-lb. box of hand driven nails to reduce paint chipping

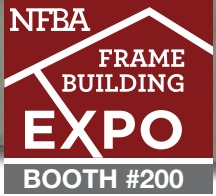

Designed for the following companies:

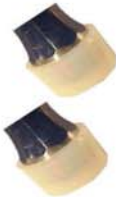

5-lb. boxes of 8d (2-1/2") painted, hand-driven nails are kept in stock - 6 boxes per case.

If the installer prefers MAZE coil nails or MAZE stick nails for pneumatic nailers, we can paint those nails too.



Circle Reader Service #306

Contact us for details on MAZE Painted Nails today!
800-435-5949 • mazenails.com

BY RURAL BUILDER STAFF



TRIANGLE FASTENER CORPORATION – FREE MARKET SPECIFIC CATALOGS

 Readers are often attracted to new products in our magazine, but in September, the buzz was generated around the release of Triangle Fastener Corporation’s new market-specific product catalogs. The free catalogs help customers to narrow down their search for products and offers details on specific construction applications. The new line-up of catalogs include: *Metal Roofing/Building*; *Low Slope (Flat) Roofing*; and *Interior/Drywall*. Each catalog provides product details on a wide variety of fasteners, sealants, tools and accessories, plus technical information and installation tips. Catalogs can be downloaded from the TFC website (trianglefastener.com). **Circle 104**



GRABER POST – POST-FRAME BUILDING PACKAGES AND MATERIALS

 In our August issue, Graber Post Buildings was included in our annual *Rural Builder Source Book* and turned heads with its continuing line-up of products. Graber Post has grown right alongside the post-frame industry, and continues to be a phone call away from acquiring all post-frame building materials and do-it-yourself packages a builder needs. GPB manufactures metal panels for any residential, commercial, industrial, agricultural or roofing application. It also produces custom trusses, metal trims, laminated poles and now features a steel coil division. **Circle 105**



PALRAM AMERICAS – SUNSKY WITH METALMATCH

 Palram Americas offers SunSky polycarbonate panels for daylighting applications. Its proprietary MetalMatch technology allows for rapid matching of existing corrugated metal profiles. As a result, Palram lays claim to developing the world’s largest catalog of corrugated polycarbonate profiles. SunSky profiles feature co-extruded UV protection. In fact, SunSky is warranted for 10 years against loss of light transmission due to yellowing and against damage due to hail. **Circle 106**



A. J. MANUFACTURING – LOW-E REFLECTIVE INSULATION

 A. J. Manufacturing is a distributor of ESP Low-E reflective insulation, the only polyethylene foam on the market. It is waterproof, insect resistant and bird resistant. When a screw is run through the microfoam, the insulation is sealed by the hundreds of micro cells, offering extra protection from roof leaks. The closed cell foam has superior PSI rating to support roof panels over purlins. It is Class A/Class 1 fire rated in foil over foil and with white face. The white face is still foil and won’t flake when exposed to UV light. ESP Low-E foam insulation is flame adhered, not glued, in a patented process and meets the requirements of NFPA 286. **Circle 107**



WHY JOIN NFBA?

You can save two ways!

Save up to **60%** on Expo registration and **50%** on membership dues when you join NFBA and register for the Frame Building Expo.*

JOIN AND REGISTER

at nfba.org/expo2016 and save two ways today!

*Some exclusions apply. A company is eligible for the 50% off membership offer only if it has never been an NFBA member or has not been a member for at least 3 years. The membership discount applies only to the first year of NFBA membership dues and does not apply to PFMI assessments or to unified chapter dues in states where applicable. Visit nfba.org for more information.

Visit nfba.org to learn about all the benefits that NFBA membership offers.

top 10 products

BY RURAL BUILDER STAFF



THE BRUT POST GRABBER



It's been the inventor's rallying cry from the beginning: "Never manhandle heavy posts again!" and it rings a chord with guys on the job who know exactly what it's like to handle timber posts the hard way. That's no doubt a major reason for why the company fared so well in our readership count for information demand. The Brut Post Grabber skid steer attachment makes easy work of post placement. This innovative attachment was designed and developed by a post-frame building contractor. The Brut solves problems with safety without physical strain and hole sloughing. Even more charming, it's made in the good ole' USA. **Circle 108**

CANNONBALL:HNP - TRACK AND TROLLEY PRODUCTS



CannonBall's expansive product lines give customers access to nearly all the accessories and components necessary to complete a post frame or metal building, and that includes track and trolley products. In 2015, the company's round track and square track lines garnered attention when the company offered some advice in our March hardware tips article. If you liked what you saw then, wait until you see what they're introducing in 2016. Check it out in the "New Products at the Expo" article starting on page 22. **Circle 109**



EXTRUTECH PLASTICS - EXTRUTECH FORM



The Extrutech Plastics "stay-in-place" concrete form for poured walls is pre-cut to project specifications and snaps together with a double-spline E-Locking System. The Extrutech FORM offers an easy-to-clean sanitary surface on both sides. The product creates a structural wall system that is builder and customer friendly for use in dairy, car washes or food facilities. Initially designed for 6-inch poured walls, it is also now available for 8-inch walls. **Circle 115**



A. B. MARTIN ROOFING - ROOFING AND SIDING PANELS



A. B. Martin Roofing is a manufacturer of quality metal roofing and siding panels including the ABM multi-purpose panel, the ABSeam standing seam panel and the PBR commercial panel. It provides building materials for pole buildings, including framing lumber, insulation, doors and windows, tongue-and-groove lumber, stalls for horse barns and much more. **Circle 116**



AZTEC WASHER COMPANY - MASTER SEAL



Because of a unique bonding process, which bonds a strong backing material to a resilient facing material, the Aztec Master Seal will perform a function that neither material could perform alone. Where sealing challenges are presented, the conical design directs the flow of the elastomeric portion toward problem areas. When problems call for cushioning or vibration control, the facing material will also provide the solution. **Circle 117**

In addition to products featured in the magazine, Rural Builder keeps note of feedback from internet newsletters. The following products are honored for receiving the most requests for information from e-news readers in 2015.



ALPINE SNOW GUARDS - SNOMAX



The SnowMax fence-style system from Alpine Snow Guards is a strong, cost-effective snow management system. It is made from aircraft-grade aluminum with increased bracket spacing, up to 48 inches on center. The SnowMax-U2 bracket fits most standard double-lock seams and the SnowMax bar accepts a 2-inch wide color insert strip to match roofing material. SnowMax is also available in configurations for both corrugated metal and membrane roofing. All products are made in the USA. **Circle 110**



FARM AND COMMERCIAL SLIDING DOOR SYSTEMS

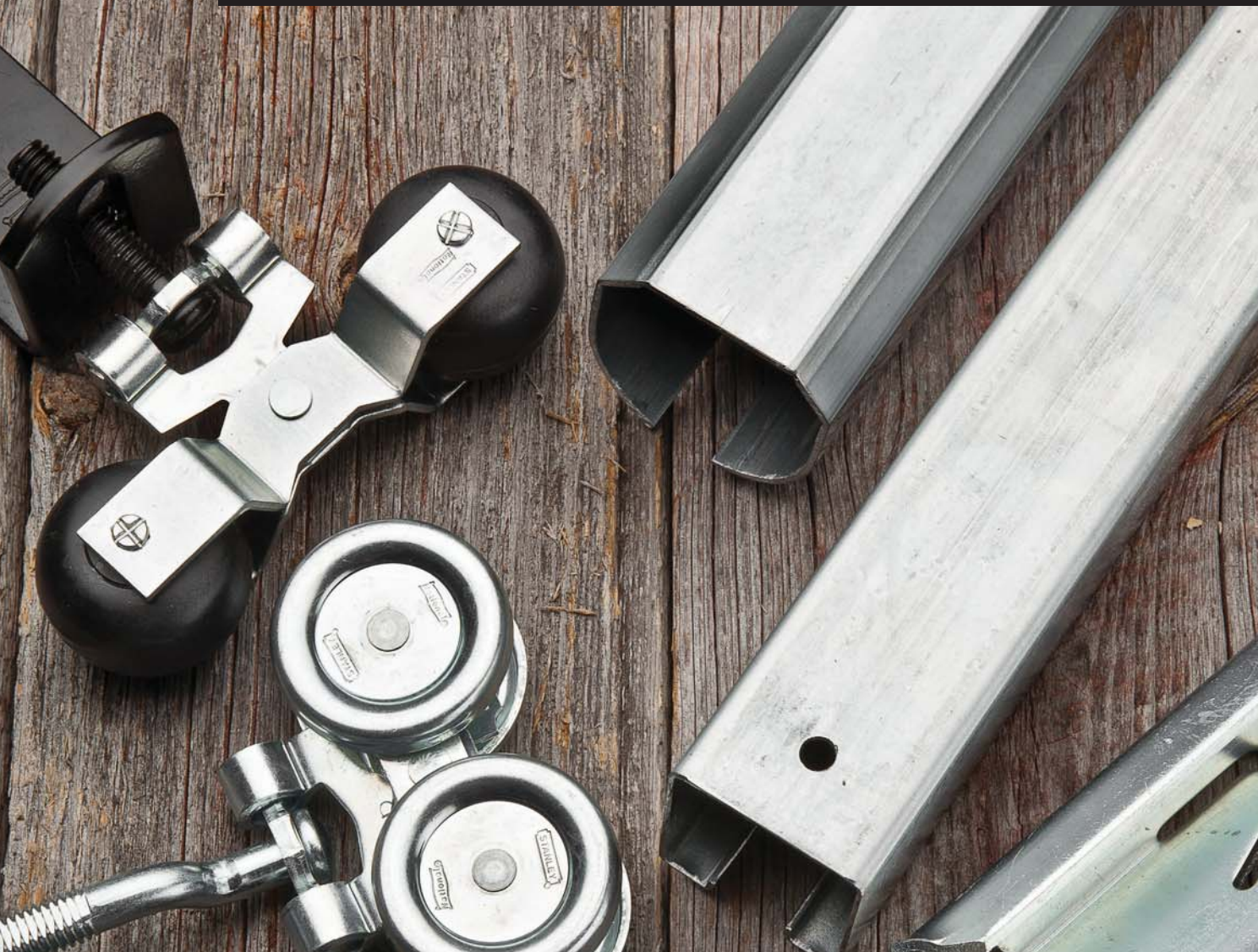

Featuring TrackMaster™ Round Rail

- Tested for more than 225,000 feet of travel
- Unique design to keep rail from rolling away from building
- Available with loose mounted or welded brackets
- Hangers available with Delrin® or hardened steel wheels

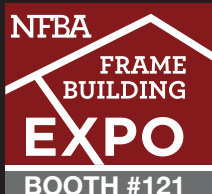

19095

Circle Reader Service #540

National
Hardware™

800.346.9445 | www.natman.com

new at the expo

BY RURAL BUILDER STAFF

Problems?

These Expo exhibitors have solutions!



visit us

The staff of *Rural Builder* and *Frame Building News* will be at the Expo. Visit us at Booth #349



CANNONBALL'S NEW TRACK AND TROLLEY LINES

CannonBall:HNP marks its 100 year anniversary in 2016 with new product offerings in its most popular product categories. **Red Roller Trolleys:** With high quality Delrin wheel components, steel construction and a dash of CannonBall Red, this updated trolley is the right eye-catcher to help lock down hardware sales on customers' round track orders. Available in CannonBall's most popular model (Stock Code 713999) this new hue, launched in January, expands to other round trolley models throughout 2016. **Interior Track Products:** CannonBall offers its first cohesive professional-grade interior track product line this April. Product models include an aesthetic Urban Flat Track design for home and commercial use and a Classic Round Track variety that provides added strength and functionality into the mix. Both lines feature beefy steel designs, black matte/powder coat finishes and a variety of sizes to handle door sizes up to 8 feet wide. **For more information circle 109**



NEW BEVEL PROFILE FOR BORAL TRUEXTERIOR

A new exhibitor at the Expo, Boral will show off three new products in its stone veneer line. It includes the recent addition of a bevel profile for its TruExterior Siding Craftsman Collection, a contemporary style combining the popular look of traditional bevel or clapboard siding, historically seen with cedar and redwood. TruExterior is the industry's first and only poly-ash siding. As a result of its blend of proprietary polymers and fly ash, the highly durable material is low maintenance, dimensionally stable, and resistant to moisture, rotting, warping, cracking, splitting and termites. At the same time, the siding's workability exceeds that of wood and can be used in ground-contact applications with no edge sealing required. Also at the show, two new colors for the Boral Versetta Stone Mortarless stone will be showcased: Mission Point and Graphite. Mission Point combines light gray and blues for a softer approach, while the more dramatic Graphite boasts a blend of near-black grays with occasional whitewashed stones. **For more information circle 122**

Cool color.
Cool impressions.
Cool savings.



NFBA
FRAME
BUILDING
EXPO
BOOTH #512



Save energy costs with cool protective coatings that create a colorful, lasting impression. With the highest solar reflective (SR) pigments in the industry, Valspar decreases environmental impact by increasing energy efficiency. Lower energy costs without sacrificing durability, performance or beauty. Call 1-888-306-2645 to speak with an expert, or visit us at valsparcoilextrusion.com/greenagenda.

valspar

Circle Reader Service #484

new at the expo

BY RURAL BUILDER STAFF

A 5/16 INCH NEWCOMER TO THE TFC BLAZER LINE

Quick...what is the largest diameter self-drilling screw readily available from stock? If you said a 1/4 inch, you would be correct—until recently. Triangle Fastener Corporation has introduced the 5/16 inch diameter Blazer 3 self-drilling screw in six lengths ranging from 1 to 8 inches. They will drill and tap metal thicknesses up to .210 inch, and have a 3/8 inch HWH that allows you to use existing tools and equipment for installation. All parts are Triseal coated and offer 1,000 hours salt spray protection from corrosion when tested according to ASTM B117. They are available with or without a galvanized bonded EPDM sealing washer. When your next project calls for increased shear or diaphragm requirements, the Blazer 3 offers an additional 460 pounds of shear strength over a 1/4 inch diameter self-drilling screw.



5/16" BLAZER Drill Screws

It also is a great "goof screw" when replacing a 1/4 inch diameter screw in a maintenance or retrofit situation. **For more information circle 123**

THE BEAUTIFUL LOOK OF WRINKLES FROM EVERLAST

There is a time when wrinkles are a good thing and Everlast Roofing has found it. The company's new Wrinkled Series uses a low-gloss, textured paint finish that can add class and character to a new or existing building. You can ask for Wrinkles on either the company's Everlast II or Everloc panels for use on residential and commercial applications. Wrinkles are tough and scratch resistant using high durability SMP. Panels are available in eight standard in-stock colors and come with a 40-year warranty. **For more information circle 124**



 **ALPINE SNOWGUARDS®**

Prevent a roof avalanche...
Keep snow in its place

Snow guards for every roof type

 • Custom solutions
• Cost-effective
• Rugged

www.alpinesnowguards.com

Circle Reader Service #317

METALCON

A FUTURE BUILT BY HAND

SPONSORED BY:



PRODUCED BY: **PSMJ** | Resources, Inc.®

Circle Reader Service #331

OCTOBER 26 - 28 • 2016

BALTIMORE • MD • USA

WWW.METALCON.COM

new at the expo

BY RURAL BUILDER STAFF

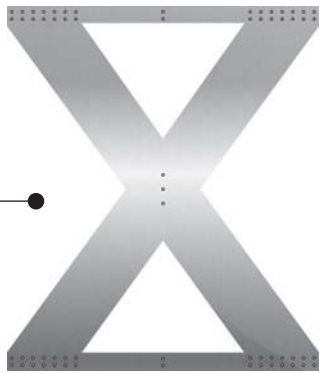

SHEAR-X STABILITY FOR CONTINUOUS RIDGE VENTS

Mother Nature can sure get into some fierce moods and to help keep buildings held together Garwood Manufacturing has developed the revolutionary Shear-X. The brace is used on continuous ridge vents in regions where wind shear and seismic activity are of particular concern. Shear-X is a 33-mil steel brace that easily installs on the ridge line of any type of roof: asphalt, shingle, metal or tile, and provides continuous load transfer across the ridge. It can be used on both flat and pitched roofs 1:12 to 20:12, on roof rafters 16 and 24 inches on center. The Shear-X allows the use of continuous ridge vents in blocked or unblocked diaphragms. Garwood also makes compatible Shear-X RidgeVent. **For more information circle 125**

GET FREE PRODUCT INFO SEE CARD BETWEEN PAGES 50-51



NAILS OF EVERY COLOR FROM MAZE NAILS

An explosion of color has hit the construction industry and today's customers like fasteners that do the job, but invisibly. Maze Nails is keeping up with the trend with more colors than ever before to match and blend with many popular siding and trim products such as Allura, James Hardie and LP Smartside. They're available double hot-dipped galvanized for hand drive and in collated sticks and coils. With hundreds of colors now available, Maze is the largest specialty nail manufacturer providing pre-finished nails for the building industry. And of course, the 168-year-old company still makes its nails in the USA. **For more information circle 126.**



AUTOMATIC STRAP LATCH SYSTEM FROM SCHWEISS

Schweiss Doors is always coming up with something new and innovative. Recognizing that it would be ideal if the straps used for lifting a Schweiss bifold door could also be used for latching it, the company came up with the Automatic Strap Latch system. The system eliminates the need for frequent maintenance required for counterpart cable lift bifold doors, including fraying, breaking and over wrapping. The Automatic Strap Latch system is easier to adjust and is safer and quieter than cable lift doors because it is manufactured with 90 percent fewer parts. Straps secure the door in all positions: open, closed and anywhere in between, even in gusts of wind during operation. Pictured is Pat Sullivan from Sullivan Family Farms in Franklin, Minnesota, who uses the new Automatic Strap Latch system on his Schweiss bifold machine shed door that measures over 47 x 18 foot. **For more information circle 127**



The most **comprehensive** guide for building with post frame



NFBA
NATIONAL FRAME BUILDING ASSOCIATION

POST-FRAME BUILDING DESIGN MANUAL

Second Edition

- Eight brand-new chapters
- More than 200 pages
- Hundreds of photos, diagrams, and design tables

Visit www.nfba.org to order your copy now.

NFBA
NATIONAL FRAME BUILDING ASSOCIATION

www.nfba.org

Circle Reader Service #378

new at the expo

BY RURAL BUILDER STAFF

SEALTITE'S MICRO-BIT DRILL POINT ELIMINATES "PIGTAIL"

Sealtite will be highlighting a change on all its post-frame fasteners at the Expo with the introduction of the new Kwickseal MB micro-bit drill point. The MB micro-bit will replace the Type 17 sharp point that has been standard on Sealtite post-frame screws since early 2000. This new drill point drills metal panels more consistently than a sharp point, eliminating slow drill or no drill situations. It will eliminate the metal "pigtail" shaving that can embed itself in a rubber sealing washer. The point creates small metal chips that can be easily swept from the roof after installation. The point will also drill multiple thicknesses of steel—commonly found at ridge cap applications—more efficiently than a sharp point Type 17. The new point will be available on all post-frame screws except #14 replacement screws.

For more information circle 128



SETTING TRUSSES A NEW WAY WITH TRUSSMATE

Builders can relate to another builder who sees a problem and fixes it. Ray Koetter, owner of Ray Koetter Construction of Floyds Knobs, Indiana, is one of those guys who knows how to fix things. He was having a hard time finding good help and wanted a way to safely set trusses when help wasn't available. His patented Trussmate is his answer to the problem. Made from solid aircraft aluminum, it installs where you would normally use a temporary tie. No men or equipment are needed in the webbing during the initial installation because it is prepared on the ground using a 1-tack nail.

For accuracy it is notched for center-line measurement. It is available in 2-, 4-, and 8-foot adjustable sets. You'll be able to check out the easy-to-use Trussmate at the Expo. For more information circle 129



800-746-8273

DOORS

- AG DOORS
- SHOP DOORS
- BARN DOORS
- AVIATION

HYDRAULIC

"One-Piece" DOOR

OR

BIFOLD

STRAP LIFT
and auto latch

NFAA
FRAME
BUILDING
EXPO
BOOTH #728

The Door Leader

SCHWEISSDOORS.com

One-Piece
...Lift Straps

Circle Reader Service #414

MC ELROY METAL MILAN SHINGLE OPTION

Options, options, options. Everyone today wants—expects—options and McElroy Metal delivers another new option with its Milan Shingle. It's ideal for homeowners and commercial building owners seeking an attractive and durable roofing solution. The 29 gauge Milan Shingle is available in eight PVDF colors as well as seven PVDF designer prints that simulate cedar shake and slate. McElroy offers a complete system, including starter edge, ridge/hip cap, gable edge trim, valley, sidewall flashing and nail clips. The interlocking Milan panels resist high winds, while the G90 galvanized steel provides fire resistance. At 25 percent of the weight of conventional asphalt shingles, Milan can be installed over most existing roofs, eliminating the expense of tear-off and disposal of any old roofing. For more information circle 130



NFBA

FRAME
BUILDING

EXPO Exhibitors

Meet the companies preparing for this year's show in Indianapolis

THE FRAME BUILDING EXPO HEADS BACK TO INDIANAPOLIS THIS YEAR MARCH 8-11.

If you want to know anything about post frame, it's the place to be. Special workshops will be held on the 8th. The trade show opens the following day, March 9, at 12:15 p. m. following the keynote address.

Here is a run-down of the companies preparing to exhibit at the trade show. As always, *Rural Builder* will be there too.

To attend the show, register online at nfba.org. If you can't attend, contact these companies any way and ask them about their products.

[Post Frame]
**Creativity AND
Innovation by Design**

March 8-11, 2016 | Indianapolis, IN

'16 FRAME BUILDING EXPO

3GM STEEL INC.

Booth 718 / Circle 135

3GM Steel Service Center, provides quality pre-painted and bare products for your metal roofing requirements. Visit them for a detailed description of items including color, gauges and widths that are inventoried and ready to ship.

A.B. MARTIN ROOFING SUPPLY LLC

Booth 608 / Circle 136

A. B. Martin Roofing is a manufacturer of quality metal roofing and siding panels including the ABM multi-purpose panel, the ABSeam standing seam panel and the PBR commercial panel. It provides building materials for pole buildings, including framing lumber, insulation, doors and windows, tongue-and-groove lumber and stalls for horse barns and much more.

A.J. MANUFACTURING INC.

Booth 628 / Circle 137

A.J. Manufacturing's 4-way universal steel frame, composite frame and aluminum frame doors with steel, fiberglass or aluminum panels will be on display in Indianapolis. A.J.'s commitment to building ideas and providing its customers and the post-frame industry the highest value solutions are just part of what you'll see on display. Expo Live! education sessions make A.J.'s booth a must-visit during your time at the Expo.



AKZO NOBEL COATINGS INC.

Booth 621 / Circle 138

AkzoNobel manufactures high performance coil coatings for the pre-painted metal construction industry, serving the commercial, agricultural, architectural and residential markets. Coil coating products include Trinar, a 70 percent PVDF coating, and Ceram-A-Star1050, which is the industry-leading silicone-modified polyester coil coating. Both are available in Cool Chemistry formulations, which help make projects more energy efficient and sustainable.



BY RURAL BUILDER STAFF

AMERICAN BUILDING COMPONENTS

Booth 241 / Circle 139

Tirelessly committed to quality products and service, American Building Components has built a strong reputation of providing premium metal roofing and building solutions that customers have relied on for more than a century. Servicing primarily the residential, commercial, post-frame and agricultural markets, ABC offers a wide variety of premium metal panels in both 29- and 26-gauge steel that are second to none.

ANCO PRODUCTS INC.

Booth 507 / Circle 140

Anco Products manufactures insulation solutions for post-frame and metal building applications.

APPLICAD-USA INC.

Booth 234 / Circle 141

AppliCad is a specialized CAD application software development company

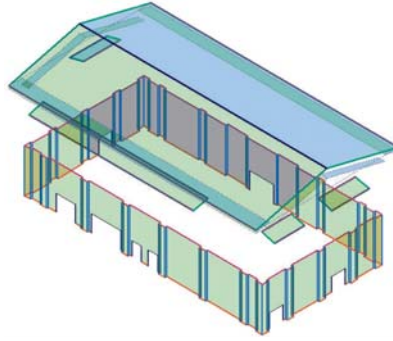

based in Melbourne, Australia. AppliCad has developed CAD applications since 1989 and now exports its specialized material and labor estimating software to roofing and cladding companies in 143 countries around the world. It also has offices in the U.S. and the U.K. Customers who benefit the most from using AppliCad's software include metal roofing and cladding installers, contractors, distributors and manufacturers. This is achieved by improving accuracy, productivity and quality of output.

ARCH WOOD PROTECTION

Booth 217 / Circle 142

Arch Wood Protection is a manufacturer of wood preservatives, including CCA and copper azole and is the licensor of the Wolmanized brand of pressure treated wood. Arch Wood's licensees produce Wolmanized building poles, timbers, lumber and plywood for agricultural, commercial, institutional and residential structures.

ASC MACHINE TOOLS INC.

Booth 514 / Circle 143

ASC is a leading manufacturer of roll forming equipment from Spokane, Washington, and has been serving the metal-forming and steel building industries for more than 65 years. With more than 1,000 manufacturing lines in production worldwide, ASC has a proven history of reliable metal forming solutions. Let ASC "Shape Your Success," improve your productivity, and enhance your profitability with the industry's most innovative roll-forming machines.



Stop Using Prime Wood Jamb Doors, In Post-Frame Structures.

Partner Door™

Do what's right for you, your customer and the industry.

For just a few dollars more you can provide your customer with a pre-finished aluminum or steel jamb door.

Partner Doors™ do not require painting or regular painting maintenance. Wood jambs left unpainted, will weather and crack as they age, leaving an unattractive, unprofessional appearance.



Wood jambs left unpainted, are subject to the elements and leave an unattractive, unprofessional finish.

A.J. Manufacturing
Partner Door—The right choice.



**- More Features
- Less Money**

SAVINGS UP TO

20%*

*Pricing varies by model



Building Ideas

A.J. Manufacturing, Inc.
1217 Oak Street
Bloomer, WI 54724
800.328.9448 www.ajdoor.com



ATLAS BOLT & SCREW CO. LLC

Booth 233 / Circle 144



The Atlas #10 WoodTite HLX Atlas High-Low Fastener is engineered with a Type 17 point to penetrate the metal panel quickly. The Atlas HLX features specialized hybrid Aster threads that reduce pigtails along with drive torque in hardwoods and knots.

The high-major with low-minor threads ensures faster drill times.



BAY INSULATION SYSTEMS

Booth 230 / Circle 145

Bay Insulation Systems is one of the nation's largest suppliers of insulation for the post-frame industry. Products include faced fiberglass, unfaced fiberglass up to 96 inches wide, a full line of insulation accessories, reflective insulation, Thermax rigid insulation, Baylight prismatic skylights and Expi-Door walk doors with fire-rated and high-security features.



THE BECKERS GROUP

Booth 522 / Circle 146

The Beckers Group is a global industrial coatings company that provides quality services and custom-made solutions across many sectors. The company is structured into three business segments: Coil Coatings, Industrial Coatings, and Consumer Design Finishes. As the world's leading supplier of high-performance coil coatings, Beckers sets new industry standards. With 21 manufacturing sites worldwide, Beckers serves customers in more than 50 countries.

BEST LINE BUILDING PRODUCTS

Booth 722 / Circle 147

Best Line is an Illinois-based company specializing in soffits, rain ware and accessories made to be perfect matches for roof and wall panels.

BEST PRODUCTS

Booth 623 / Circle 148

Best Products will be showcasing specially designed laminated wood columns. The patent pending Mega Spacer allows the column notch to easily accommodate the truss with a gusset plate. There is no more need for prying or fighting the notch pocket while setting

MB™ New Micro-Bit™ Engineering
Stronger, More Consistent, Drill Point

The #1 complaint regarding sharp point screws is that they often drill slowly or not at all. SEALTITE has married its metal building fastener technology into its new KWIKSEAL® MB™ with micro-bit engineering. This KWIKSEAL® MB™ will eliminate the slow drill or no drill complaint. The transition thread will still generate superior holding strength in all wood substrates. The point will generate small metal shavings & eliminate the long "pigtail" prevalent with sharp point screws. It all adds up to a cleaner, more consistent application.



Easy Multi-Layer Penetration
The MICRO-BIT will penetrate multiple thicknesses of metal panel often found at ridge cap applications more consistently than sharp point screws.



Eliminates Slow or No Drill



No Pig Tails

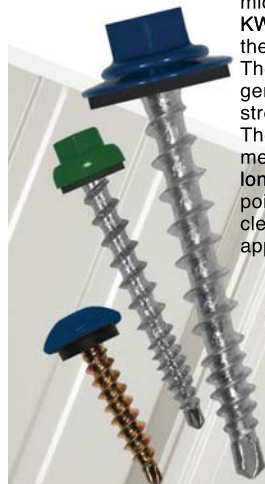

Call Today 800-352-4864



© 2016 Sealtite Building Fasteners

NEW QUAD[®] MAX

THE FIRST LINE OF
DEFENSE AGAINST
THE ELEMENTS.

Simply put, QUAD[®] MAX delivers the toughness that really makes a job last. By providing superior protection against air and moisture, it gives you zero reasons to worry about a job once you've done it right the first time.

COME GET SOME AT
OSITOUGH.COM

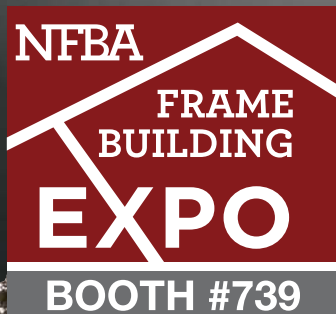

QUAD® INVISIBLE

THE BATTLE
AGAINST THE
ELEMENTS
JUST BECAME
CLEAR

QUAD® INVISIBLE provides all the great benefits of QUAD®, plus the most invisible formula available in the market. Bonds without a primer to most common substrates like painted or stained woods, coated aluminum, steel, metal, brick, and concrete. The difference is now clear.

COME GET SOME AT
OSITOUGH.COM

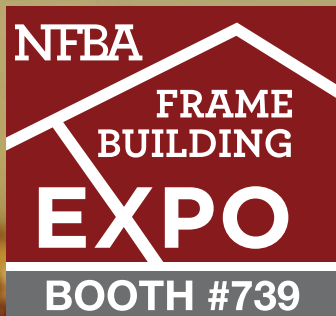

expo exhibitors

BY RURAL BUILDER STAFF



Boral

trusses thus saving time and money, along with providing a safer work environment.

BORAL

Booth 701 / Circle 149

Boral is introducing two new, innovative options that will change the way you look at exterior products. Offering phenomenal performance, remarkable workability and a lasting look, Boral TruExterior siding and trim are the only products available today that solve both the moisture- and movement-related issues commonly seen with other exterior materi-

Borkholder Buildings and Supply



als. Made from the revolutionary new polychrome material, Boral TruExterior siding and trim are truly like no other products on the market. Boral Versetta Stone is a mortarless, cement-based manufactured stone veneer with a unique, paneled design that is installed with mechanical fasteners, allowing carpenters and contractors to recreate the beauty and craftsmanship of authentic stone masonry using nails or screws, offering a complete system founded on quality, speed and selection.

BORKHOLDER BUILDINGS AND SUPPLY

Booth 228 / Circle 150

For more than 50 years, Borkholder Buildings and Supply has been providing post-frame buildings. In its Midwest dealership program, it provides building packages including engineering and professional design. Unique and innovative truss production ensures that your building will be







Replaces Concrete Footings Of Equal Diameter

FootingPad® - Available in 10", 12" and 16"

Ditch the Concrete!

Is your below-grade footing ICC code-compliant?

FootingPad® meets the ICC-ES building code acceptance criteria (AC408). Certified by ICC Evaluation Service (ESR-2147).

www.footingpad.com 800-522-2426

©2016 AG-CO, Inc., Patent No. 7827747, Made in USA



Weights 4 lbs.

vs.





Weights 90 lbs.

16" FootingPad®

Total Allowable Load: 4,167#
Based on 3,000 psf soil capacity

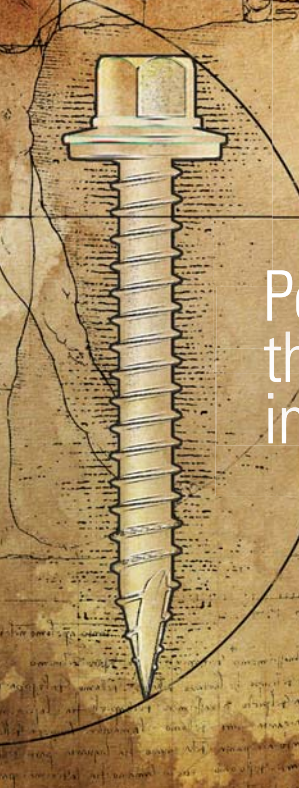
16" Concrete Pad





Performance through innovation.

Proof that passion, imagination, experience and intense attention to detail can help deliver weathertight buildings.

atlasfasteners.com

VISIT BOOTH 233 AT THE 2016 FRAME BUILDING EXPO

Circle Reader Service #524

Circle Reader Service #328



The Bradbury Group

at a high quality level. Borkholder has also developed high energy-efficient homes and buildings such as Net Zero Energy Homes.

THE BRADBURY GROUP

Booth 527 / Circle 151

The Bradbury Group of companies make an extensive line of roll-forming equipment including panel and trim roll formers, folders, slitters, and recoil lines for the production of trim, gutter machines, insulated panel lines, and turnkey metal tile/shingle plants. It offers equipment options for the startup producer as well as the established manufacturer. Bradbury is known for cutting edge technology and reliability built into every product.



The Brut Post Grabber

THE BRUT POST GRABBER

Booth 415 / Circle 152

Never manhandle heavy posts again! The Brut Post Grabber skid steer attachment makes easy work of post placement. This innovative attachment was designed and developed by a post-frame building



Burrow's Post Frame Supply

contractor. The Brut solves problems of safety, physical strain and hole sloughing. And, it's made in the USA.

BURROW'S POST FRAME SUPPLY

Booth 622 / Circle 153

Burrow's Post-Frame Supply is an integrated manufacturer and turnkey supplier of construction materials for the post-frame construction market. The company roll forms steel siding and steel roofing, custom manufactures wood trusses and laminated posts and manages a massive inventory of related lumber, steel trim and post-frame accessories. The relationships Burrow's builds with its distributor part-

GRABER POST IS HOSTING A RECEPTION AT THE 2016 FRAME BUILDING EXPO

GRABER POST HOSPITALITY

Reception
"FEATURING WILL STOLTZ"

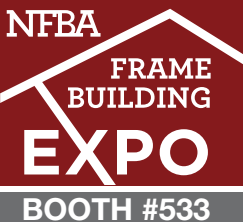

THURSDAY MARCH 10TH
INDIANAPOLIS MARRIOTT DOWNTOWN
350 W. MARYLAND ST., INDIANPOLIS, IN 46225
8:00-11:00 PM - BALLROOM INDIANA E-G
DRINKS, HORS D'OEUVRES LIVE MUSIC

7716 N. 900 E. Montgomery, Indiana 47558
800-264-5013 | Fax 812-636-4936
www.graberpost.com



expo exhibitors

BY RURAL BUILDER STAFF

ners and builder-end customers are guided by the fact that it is stubborn about quality in everything it does for them.

CANNONBALL:HNP

Booth 227 / Circle 154

CannonBall:HNP is a leading supplier of components for the post-frame and metal building industries. Since 1916, CannonBall has offered the most complete line of round track products and accessories—including industry-standard Keyhole Track and Quick Track. The wide variety of entry doors are manufactured with versatile design and affordable pricing for the agricultural, commercial and metal building markets. Builders also rely on CannonBall for quality Dutch doors, cupolas, horse stalls, windows, builders' hardware and more.

CAPITAL FOREST PRODUCTS

Booth 440 / Circle 155

Capital Forest Products has been successfully marketing lumber products for

more than 30 years and is proud to be one of the nation's largest stocking distributors of Eastern White Pine, SPF and SYP. It contributes its growth to intimate relationships with both customers and specialty mills and is positioned to service a variety of accounts. Capital is also a stocking distributor of all Titanium synthetic roofing underlayments including Rhino Roof.

CARTER LUMBER

Booth 316 / Circle 156

Founded in 1932, today Carter Lumber is one of the nation's top building materials retailers. More than just a lumberyard, the Carter Lumber family of companies is dedicated to providing builders and do-it-yourselfers with a broad range of quality building materials and exceptional customer service.

CENTRAL STATES MFG. INC.

Booth 501 / Circle 157

Central States manufactures metal building components for the post-frame,



light-gauge, architectural, residential and commercial markets. Offerings include both exposed and concealed fastener panel profiles, as well as trapezoidal standing seam panels in a selection of gauges, colors and warranties. Trim and purlins are also available. Complete mini, boat and RV storage packages are available through the Central Storage Works division.

C.H.I. OVERHEAD DOORS

Booth 318 / Circle 158

If you are in the market for a residential, commercial or rolling-steel overhead

MASTER FLASH® 35 YEAR

THE ONLY ICC FLASHING OF ITS KIND,
Listed with the Florida & California Building Codes.



35
YEAR
WARRANTY



Compliance with the following Codes:

International Building Code® (IBC) • International Residential Code® (IRC)
California Building Code® (CBC) • California Residential Code® (CRC)
Florida Building Code® (IBC) • Florida Residential Code® (IRC)



1-800-WASHER 5 (927-4375) • Fax: 858-513-4305
www.aztecwasher.com • sales@aztecwasher.com

Circle Reader Service #441

chiod.com residential | commercial | rolling steel

BOOTH# 318

C.H.I. OVERHEAD DOORS
The Door to Quality.™

accents woodtones
from C.H.I. OVERHEAD DOORS

Circle Reader Service #553



door, look no further than C.H.I. Overhead Doors. The company, through its commitment to quality and value recognizes the importance of delivering a reliable product. C.H.I. offers an impressive selection of models in a wide range of sizes so you can find a garage door to match your exact specifications.

CIDAN MACHINERY
Booth 516 / Circle 159

Cidan Machinery offers a complete line of metal forming devices. Whether you're looking for capacity, utility, flexibility, effi-

ciency or economy, Cidan has a model that fits your needs.

CLARK INDUSTRIES INC.
Booth 709 / Circle 160

Clark Industries Inc., Monett, Missouri is a privately owned and operated company that has been supplying the building components industry with manufacturing equipment, parts and service for more than 35 years.

DIRECT METALS INC.
Booth 705 / Circle 161

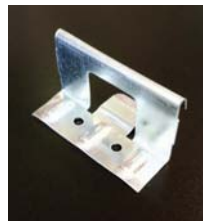

Direct Metals Inc. is a master distributor of many products for the post-frame building market including fasteners, flashings, insulation, ridge vents, closures, sealants, anchors, doors and door hardware. American-made products, such as

Razorback Ridgeback and standing seam metal roof clips are now in stock at the Midwest Service Center in Plymouth, Indiana. Visit the booth for a catalog.

DL TRUSS/ STRUCTURAL GLULAM LLC
Booth 706 / Circle 162

Structural Glulam LLC, a division of DL Truss manufactures quality laminated timbers, glulam posts and headers from #1 Southern Yellow Pine. Its 3- and 4-lamination trusses are treated 0.60 retention, feature glued finger joints and come in standard lengths up to 36 feet. For 15 years DL Truss has manufactured roof trusses and wood structures, providing excellent customer service at a very competitive rate.

DURA COAT PRODUCTS INC.
Booth 124 / Circle 163

Dura Coat specializes in high-quality, high-performance coil coatings for commercial, farm and residential applications. Durapon 70 is a PVDF formulation equal

beck
FASTENER GROUP

YouTube f Twitter

Work Faster.
Relax Sooner.

Frame Building Expo
Booth #324

Fine Threads for superior withdrawal values
Coarse Threads for superior removal performance

SCRAIL®
The Faster Fastener™

- Speed that gets you home faster, with a job well done
- Twice as fast as collated screws
- Eight times faster than bulk screws
- Versatile - use almost anywhere ordinary screws are used

Master Distributor
FASCO
AMERICA

Get professionally connected by visiting
www.fascoamerica.com
or call 800-239-8665.

BECK Fastener Group®, FASCO America®, SCRAIL® and "The Faster Fastener™" are registered trademarks of the BECK Fastener Group.

Circle Reader Service #359

ATTENTION
Stop setting posts the hard way!

The Brut Post Grabber
Skid Steer Attachment
Patent Pending

This product is patent pending

Rural Builder 2015
TOP 10 PRODUCT

Check out our video at: www.TheBrutPostGrabber.com

- Eliminate Injuries
- Fast, Effortless Post Setting at Last
- Amazing for Setting into Sauna Tube Projects
- Rental Yards

The perfect / effortless way to set posts attached to "Perma Columns"

Ask about our "Round Pole Grabber"
Great for setting poles and grabbing trees and brush

SEE US AT FRAME BUILDING EXPO, BOOTH #415

Ask for Scott: 208-964-6666 *President/Creator of the "Brut"*

Circle Reader Service #315

expo exhibitors

BY RURAL BUILDER STAFF

to or better than any coating on the market. With an exceptional resistance to installation scratching, scuffing and transit abrasion, it is also flexible enough to handle demanding post-forming. The unique chemistry of Durapon 70 reduces the carbon footprint which makes a greener product. Ceramel XT-40 SMP is a proprietary polymer formulation that is harder and more flexible and significantly more abrasion- and stain-resistant than conventional coatings. Ceramic pigmentation prompted the name, Ceramel. It runs like a dream at all speeds and has excellent flexibility, weathering and fade resistance properties. Both coatings are energy efficient and meet Energy Star standards.

DYNAMIC FASTENER

Booth 135 / Circle 164

Dynamic Fastener offers same-day shipping of screws, anchors, flashing, safety equipment, hand tools and power tools. Also available is in-house painting of screws and rivets, with one- or two-day lead times. The company's free 32 page, full color tool and fastener hand guide provides engineering data and explains product offering. Locations include Kansas City, Missouri (main office); Chicago; Houston, Memphis; St. Louis; and St. Paul, Minnesota.



EAGLE METAL PRODUCTS

Booth 208 / Circle 165

Eagle has been serving component manufacturers for more than 30 years with truss connector plates, TrueBuild structural design software, engineering services and manufacturing equipment, and is committed to providing exceptional products and customer service. Manufacturers across the country are discovering the advantages. Visit them at the Expo to learn more. "Eagle Metal Products... Engineered. Tested. True."

EAST COAST FASTENERS

Booth 408 / Circle 166

East Coast Fasteners produces durable, long-lasting fasteners for all combinations of building materials. For fastening wood, aluminum, steel or any variety of applications the East Coast fastener line is manufactured to superior quality standards for optimal performance.



Ultraseal protective coating improves corrosion resistance giving East Coast's fasteners increased life expectancy. Each order is computerized color matched exactly to the customer's specifications. With a variety of coatings to assure the builder has the best product on the market and the fastest cutting tips, East Coast fasteners are

Lakeside Construction Fasteners offer a full line of innovative wood fasteners for post frame and residential applications. The **T17 WOOD-X™** is designed for all types of decking substrate materials including hard woods. The engineered **T17 WOOD-X™** high-low threads along with the sharp cut point allows the fastener to quickly penetrate the metal panel for easier fastener installation!

National Frame Building Expo
Booth #313

IRE Booth #2150

T17 WOOD-X™ SYSTEM:

- Miami Dade County Approved!
- H-LOW™ threads for Speed of Installation!
- T17 Cut point developed for High Performance!
- Engineered head flute resists High Torque Environments!
- Innovative L3 Dura Protec™ coating to prevent Red Rust!
- EPDM washer for a Positive Seal!

To purchase contact us at:
6476 Highway 135 North, Paragould, AR 72450
870-586-0703 (office) • 870-586-0643 (fax)
800-537-4160 (toll free)
www.lakeside-fasteners.com

SAVE TIME AND MONEY WITH THERMA SHEET

Now certified by the International Coding Council (ICC) as a stand-alone roofing underlayment:

- Metal roofing
- Stone coated steel
- Concrete
- Clay tile and more

Visit ESP Low-E at the Frame Building Expo, Booth 216, March 8 - 11 in Indianapolis.

LOW-E THERMA SHEET
 ROOFING UNDERLAYMENT

(800) 289-5693 • www.low-e.com

Circle Reader Service #469

Circle Reader Service #319

manufactured to standards that assure fast and reliable installation every time.



ENERGY PANEL STRUCTURES

Booth 210 / Circle 167

Energy Panel Structures specializes in pre-engineered buildings and tilt-up panel systems for all types of construction. Since 1981 EPS has offered only the best building designs in commercial, agricultural, residential and cold storage.

ENTREMATIC/AMARR

Booth 213 / Circle 168

Amarr is a part of Entrematic, a company comprised of well-established entrance automation brands with nearly 200 years of cumulative experience. Entrematic pro-



vides one of the world's most complete ranges of entrance automation products and warehouse solutions. Established in 1951, Amarr is one of the world's leading brands in design, manufacturing and distribution of sectional doors for residential and commercial applications. Made in the U.S., Amarr products have a legacy of innovation and high quality design.

ENVIRONMENTALLY SAFE PRODUCTS INC.

Booth 216 / Circle 169

Environmentally Safe Products Inc., located in New Oxford, Pennsylvania and Carson City, Nevada, is a producer of high-quality building insulation products for residential, commercial, industrial and



agricultural building industries. ESP's signature offering, Low-E Reflective Insulation, is a patented product that blocks 97 percent of radiant heat.

EVERLAST ROOFING INC.

Booth 540 / Circle 170

Everlast Roofing's metal and siding is uniquely superior to anything else on the market. Creating this success is the one-of-a-kind heat forming process, which prevents microscopic paint cracks. This enables the use of harder, more scratch-resistant paints. Offering a variety of gaug-

THE ONLY ONE-STEP FASTENER!

for fiberglass or PVC panels!

Master One-Steppers® are the only time-saving one step screws for attaching panels that exhibit thermal expansion to wood frame structures. The revolutionary patented design self-drills an expansion hole, automatically centers, drives in and provides a cushioned expansion-seal in ONE STEP! No pre-drilling. No panel cracking!

Master One-Steppers® are available in 304 and 410 stainless steel, or in carbon steel with Leland's renowned long-life platings and powder coatings. Find out more today!

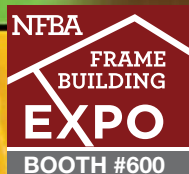

Toll Free: 1-800-263-3303
www.lelandindustries.com

Demand North American Quality!



Hexavalent Chromium Free!
It's the law.

expo exhibitors

BY RURAL BUILDER STAFF

es, colors and custom trims to suit every customer's application makes Everlast Roofing the perfect choice for the agricultural, commercial and residential markets.



EXTRUTECH PLASTICS INC.

Booth 307 / Circle 171

At the 2016 Frame Building Expo, Extrutech Plastics, Inc. will be introducing its new 8 inch "stay in place" concrete form for poured walls. The Extrutech FORM is 24 inches wide and snaps together for quick installation. This FORM offers an easy-to-clean sanitary surface on both sides. The product creates a structural wall system that is builder and customer friendly and can be used in dairy, car wash or food facilities.

FABRAL

Booth 717 / Circle 172

As the post-frame leader of choice, Fabral offers metal panel systems, components and accessories for agricultural, light commercial and residential structures. Its high-performance product line provides a solution for every project and budget. Backed by the best customer support in the industry, Fabral works with you to get the job done right.



FASCO AMERICA

Booth 324 / Circle 173

Fasco America offers a full range of Jumbo Nails and two well-designed tool models to conquer your BIG timber framing jobs. These tools have a side handle for extra support while driving the Jumbo

Nails. Jumbo Nails are available in 4 inch to 6-3/8 inch lengths and can be ordered in many different finishes, shank deformations, points, and collations to meet your exact needs.

FASTENERS DIRECT LLC

Booth 746 / Circle 174

Fasteners Direct LLC is a manufacturer of screws and a distributor of accessories for metal companies. The company's manufactured parts are distinguished for their unequaled resistance to corrosion and for the anti-back-out feature of their Sureloc metal-to-wood screw, and for the new Torpedo point on their metal-to-metal screws. The Torpedo point delivers the fastest installation rate for self-drilling screws in the industry. Fasteners Direct is also the national distributor for Condensstop condensation control coils.

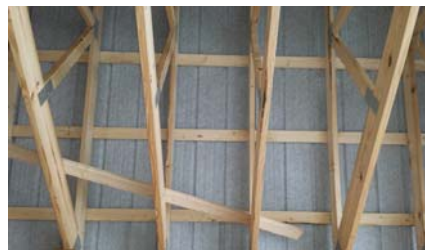

FILC USA/DRIPSTOP

Booth 412 / Circle 175

Dripstop from Filc USA helps fight condensation without insulation. Dripstop has specially-designed air pockets that store condensation and hold it until conditions change and it evaporates back into humidity. Because it arrives at the job site already on the steel, there are no costs for installing insulation, plus it saves time by removing one step of the building process and helps fight corrosion by adding another layer of protection from the corrosive elements found in livestock confinement.

FOOTINGPADS AND CUPOLAS BY AG-CO

Booth 122 / Circle 176

FootingPad replaces concrete footings of equal diameter. This unique and lightweight product is designed to help raise post-frame buildings in record time. FootingPad's patented technology evenly distributes post loads and saves hours of backbreaking work while meeting the ICC-ES building code acceptance criteria (AC49). FootingPad is ICC code compliant



and provides durability and strength. "Save time. Less mess. Less hassle."

FRAME BUILDING NEWS/RURAL BUILDER

Booth 349 / Circle 177

Stop by the booth and visit with the sale and editorial staff of *Frame Building News* (the official publication of the NFBA) and *Rural Builder*: your year-round resources for information on post frame.

FREE STATE LUMBER CO.

Booth 721 / Circle 178

Since 1973 Free State Lumber has always let its customer needs be the first priority. Filling orders for customers and supplying them with quality products in a timely manner is what makes them successful. Free State has many years of experience supplying a variety of materials to distribution facilities, retailers, post frame, agricultural, and shed builders. It has one of the largest inventories in the Eastern U.S. and offers CCA and MCA treating; custom millwork (a variety of tongue and groove patterns) on 2- and 3-foot lumber; precision end trimming; custom re-sawing; dadoed 4x6 runners for buildings; from 1x4 boards to 12x12 timbers; plus a large variety of treated panels.

GRABER POST BUILDINGS INC.

Booth 533 / Circle 179

Grabber Post has everything for a post-frame structure or metal roofing project. GPB manufactures metal panels for any residential, commercial, industrial, agricultural or roofing application. Grabber Post also produces custom trusses, metal trims, laminated poles and now also features a steel coil division. GPB saves time and money by supplying all needed materials with just one phone call. Wholesale customers/distributors are desired.

H & H METAL PRODUCTS INC.

Booth 645 / Circle 180

H&H manufactures and distributes quality steel roofing and siding products and accessories for the post-frame building and residential roofing markets, including CondenStop. CondenStop is a highly absorbent, layered fleece material containing millions of micro spheres that absorb and contain condensed water. It prevents dripping inside the building until the water evaporates.



HERSHEY'S METAL MEISTER LLC

Booth 735 / Circle 181

Hershey's Metal Meister of Mattoon, Illinois, now assembles the Variobend folding machines, which were designed in

Europe for speed and accuracy. Single and double folders have an outstanding design and unique profile variety. Hershey's Metal Meister has experience in roll forming and designing equipment.

HIAB USA INC.

Booth 224 / Circle 182

Hiab is the world's leading provider of on-road load handling equipment. Its high performance products include loader cranes, forestry and recycling cranes, demountables, truck-mounted forklifts and tail lifts.

HOOVER TREATED WOOD PRODUCTS INC.

Booth 442 / Circle 183

Hoover Treated Wood Products Inc., in business since 1955, supplies a comprehensive portfolio of pressure-impregnated kiln-dried lumber and plywood products for fire retardant and preservative applications. Hoover has five company-owned



treating facilities conveniently located to service a 100-plus member stocking distributor network, which thoroughly covers the USA and Canada. The rigorous quality control procedures employed by Hoover are constantly reviewed and inspected by Underwriters Laboratories and Timber Products Inspection's follow-up services.

HÖRMANN LLC

Booth 130 / Circle 184

As one of the world's leading manufacturers of doors, Hörmann is committed to providing a wide selection of German-engineered and American-made products.



ECO-FRIENDLY PRODUCTS



Manufacturer of Over 100 Environmentally Safe Insulating Ceramic Waterproofing Paints and Coatings

www.nationwidecoatings.com



RESIDENTIAL - COMMERCIAL - INDUSTRIAL

INTERIOR CERAMIC PAINTS

EXTERIOR CERAMIC PAINTS

ELASTOMERIC WALL COATINGS

PROTECTIVE WOOD & DECK FINISH

CLEAR ACRYLIC ROOF COATINGS

ELASTOMERIC ROOF COATINGS







ELASTOMERIC WATERPROOFING INSULATING CERAMIC ROOF COATINGS - ZERO V.O.C. INSULATING CERAMIC INTERIOR & EXTERIOR PAINTS

ELASTOMERIC CERAMIC WALL, TEXTURE & INDUSTRIAL COATINGS - CONCRETE & DECK PAINTS, STAINS, CLEAR COATS & SEALERS

WOOD STAINS, CLEARS & DECK-OVER COATINGS - EPOXIES - COLOR MATCHING & CUSTOM FORMULATIONS

CALL TODAY FOR FREE SALES & MARKETING BOOK!



NATIONWIDE PROTECTIVE COATING MANUFACTURERS, INC.
SARASOTA - FLORIDA - USA



The PERMANENT Coating Solution™
1.800.423.7264  941.753.7500

expo exhibitors

BY RURAL BUILDER STAFF

It includes the Orion 3200 (insulated sandwich), Phoenix 5200 (carriage house style) residential doors and the new Tucana 5250 recessed panel insulated sandwich door, along with the Silent Driver 7500 garage door opener. Doors come standard with FingerGuard pinch-resistant section joints for safety, plus 3-layer sandwich construction with polystyrene core and in-between section seals for increased energy efficiency.

I-BEAM SLIDING DOORS

Booth 117 / Circle 185

I-Beam Sliding Doors is a company founded on building heavy duty, lightweight sliding doors for the post-frame industry. The company prides itself in supplying doors to fit your needs. "Doors That Work!" Now with the 6000# Ultra Glide track and trolley system.

INDIANA WARM FLOORS INC.

Booth 441 / Circle 186

Since 1979 Indiana Warm Floors has been the authority in radiant floor heat,

specializing in snow-melt systems, radiant floor heat, geo-thermal heat pumps, IR tube heat, on-demand tank-less water heaters, and wood boilers. Radiant heat provides long-term energy efficiency with reduced operational and maintenance costs. Radiant heating is truly remarkable heat and is superior to traditional heating systems, requiring up to 30 percent less energy than a gas-heating unit.



ISAIAH INDUSTRIES

Booth 714 / Circle 187

Isaiah Industries is a leading manufacturer of specialty metal roofing and a distribu-

tor of premium underlayments and ice and water shields. Through superior customer service, marketing support, and the industry's fastest lead times, Isaiah Industries serves manufacturers and contractors with beautiful metal shingles that emulate traditional shakes, shingles, slate, and tile and its RoofAquaGuard underlayments.

JANUS INTERNATIONAL

Booth 127 / Circle 188

Janus International is the leading manufacturer of roll-up doors for the commercial and self-storage markets. Headquartered in Temple, Georgia, Janus has five domestic locations and two international facilities. Ease of use, quick delivery, unparalleled warranty and strong customer support has made Janus a favorite with door dealers nationwide since 2002.





MRS
METAL ROLLFORMING SYSTEMS





The Affordable Rollforming Equipment Manufacturer

Metal Rollforming Systems designs and manufactures reliable and affordable rollforming equipment and accessories, making us a leader in rollforming equipment manufacturing. Our unsurpassed technical support is unlike any other in the industry, we work until the job is done. Our customer's success is our success. For more information, please contact us at 1.888.284.6794 or visit us online.

- Single & Double Deck Rollformers
- Trim Rollformers
- *NEW* Patriot Rollforming Line
- Coil Reels

- Precision Cut Slitting Lines
- Sheet Stackers
- Coil Upenders
- Ridge-Cap Press





1.888.284.6794 www.mrsrollform.com

Circle Reader Service #584

Novaflex. The flexible seal that lasts as long as the roof.



Your reputation depends in large part on the materials you use. Build a reputation for dependable performance with Novaflex® Metal Roof Sealant. Novaflex gives you superior flexibility and adhesion to most construction materials, including metal, coated metal, wood, masonry, PVC, and Kynar.® It's easy to apply, especially in cold weather, and easy to clean.



When you want the seal to last®

www.novagard.com

Visit us at Frame Building Expo Booth #518

Circle Reader Service #290



K&K INDUSTRIES INC.

Booth 128 / Circle 258

K&K Industries started more than 40 years ago in 1972. The business started with three employees, a small plant and one delivery truck. Currently, K&K Industries employs about 100 persons and has 12 delivery trucks. It not only manufactures custom roof trusses, but also makes customized wood floor trusses and wall panels. Laminated beams, I-joist and Smartsiding (primed and pre-finished) have also become a large part of its product line.

KENWOOD PAINTED METALS

Booth 618 / Circle 189

Kenwood is a single source supplier for pre-painted metal for the construction and door industries with more than 30 years



experience in the coil coating industry. It is a value-added supplier of pre-painted steel that will manage your supply chain with stocking locations throughout the United States.

KLOECKNER METALS

Booth 723 / Circle 190

Kloeckner offers painted and bare coils for roll forming of building panels and components. Distribution is available throughout the U.S. Kloeckner, offering more than 160 colors provides paint systems in multiple grades, widths and substrates from Valspar, AkzoNobel and Dura Coat. Bare and acrylic-coated products,



along with cold rolled, stainless and aluminum coil are stocked across the country. Kloeckner also distributes plate, beams, structurals, pipe and tubing. The company is headquartered in Roswell, Georgia, and consists of three business segments: Flat Rolled Group, Heavy Carbon Group, and

Match virtually any custom profile with SunSky in days.

Get the leading corrugated polycarbonate delivered fast to fit most any metal profile with SunSky® MetalMatch™ technology. So you can add value and more daylight to projects in as little as two weeks. And MetalMatch is available at an extremely attractive price.



More daylighting options. More easily.

SunSky's first-in-class durability, high performance and superior light transmission are ideal for roof, side and skylight applications. So you can expand unique design possibilities, reduce energy costs, and enhance environments with more natural light. Available in several opacities,



including Soft White, SunSky is backed by a 10-year warranty. To learn more, contact your local distributor or call **800-999-9459**. Or visit us at www.PalramAmericas.com/MyProfile. We'll take the perfect ribbing and make it even better.



Circle Reader Service #350

expo exhibitors

BY RURAL BUILDER STAFF

the Special Products Group which consists of building products.

LAKESIDE CONSTRUCTION FASTENERS

Booth 313 / Circle 191

Lakeside Construction Fasteners, a full service international manufacturing and distribution company offers vast fastener solutions for the metal building industry. The T17 Wood-X #10 x 1 to 4 inch is designed for decking substrate materials including hardwoods. The T17 Wood-X high-low threads and sharp cut point allows the fastener to quickly penetrate the metal panel. With a quality focus, the T17 Wood-X can be used with battery-operated screw guns including impact screw guns.

LELAND INDUSTRIES

Booth 600 / Circle 192

Leland boasts the fastener industry's first "long-life" powder coating warranty to match WeatherX, Spectracote

and Perspectracote paint systems. Leland manufactures a complete line of fasteners for metal roofing, wood frame or steel frame projects, offering self-drilling and self-tapping fasteners in lengths to 4 inches in #10-12 and 14 diameters. Lengths up to 8 inches are also available. Leland fasteners are made of carbon or stainless steel, plated, and coated or powder coated to match panel colors. Leland's powder coating covers both the head as well as under the head where corrosion starts.

LESTER BUILDING SYSTEMS LLC

Booth 221 / Circle 193

Lester Building Systems is a leading post-frame company with more than 150,000 buildings constructed since 1947. In support of its engineered building systems, Lester offers a lifetime structural warranty unmatched by others. Lester Buildings' dealers are empowered with Improv, an exclusive software that promptly designs, engineers, prices and draws buildings.



LEVI'S BUILDING COMPONENTS

Booth 627 / Circle 194

Levi's Snow Defender series is your perfect choice for snow retention that will outlast your roof. There are plenty of choices



10550 TR 262, Millersburg, OH 44654
Phone (330) 674-4003 Fax (330) 674-4035

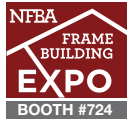

Manufacturer of metal forming equipment, for commercial and residential construction use, using D2 tool steel as a standard.



- Ag Panel
- Ridge Cap
- Hemmer
- Slitter
- Uncoiler
- Uncoiler w/Car
- Corner
- Facia
- Soffit
- Drip Edge
- J Channel
- Double Angle
- Rat Guard
- Perforator
- Coil Upender
- Panel Wrapper
- Trim Wrapper
- Cannon Ball
- Track
- Rolls and Tables
- Stand Alone Shear



Circle Reader Service #516

Rural Builder

YOUR VOTE COUNTS!

GOLD KEY

of Excellence Awards

In July, *Rural Builder* magazine will present its **Gold Key of Excellence Awards** for the 34th time. Help us determine the names of suppliers of building materials and/or construction equipment who do the best job of providing you with all of the services and products you need to run your business successfully.

Take a minute to submit your vote today.

Criteria to consider when making your choices include:

- Quality of customer service
- Product quality
- Within budget
- On-time delivery
- Warranty procedures
- No surprises

Nominate up to three suppliers in the spaces provided below.

1. Company Name & Location _____

2. Company Name & Location _____

3. Company Name & Location _____

Your name: _____

Company: _____ Location: _____

(Your information will remain confidential.)

PLEASE RETURN YOUR BALLOT NO LATER THAN APRIL 15, 2016 TO:

Rural Builder, 700 E. State St., Iola, WI 54990-0001

Fax: 1-715-445-4087 attn. Sharon Thatcher • **E-mail:** sharon.thatcher@fwcommunity.com

in several styles and over 40 quick-ship colors. Made with quality in the USA, Snow Defender features a 15-year warranty. Consult Levi's website for detailed product descriptions and to use Levi's handy snow guard calculator to determine your roof's exact number of guards needed.

LIBERTY STEEL PRODUCTS INC.

Booth 613 / Circle 195

Andrew and James Weller founded Liberty Steel Products in January of 1965. Today, the business operates two ISO 9001:2008 certified steel servicing and processing plants in Northeast Ohio. Headquartered in North Jackson, Ohio, Liberty Steel Products processes all types of flat rolled carbon steel. Its innovative handling, staging and delivery systems are designed to enable its customers to meet the rigorous demands of the 21st Century operation. Liberty Steel Inc. also offers a complete lineup of pre-painted products to the metal building industry. Now in its fourth year of stocking pre-painted

coils, its customer base is growing rapidly. LSP Inc. has established relationships with coating lines, paint companies and mills throughout the world, allowing it to offer the same just-in-time services to both new and existing customers requiring a pre-painted product at a competitive price.



MAC METAL

Booth 317 / Circle 196

MAC Metal is pleased to offer complete package post-frame buildings to customers in its service area. Features include engineered trusses, 8x8-inch treated posts, and many more options to choose from.

MARCO INDUSTRIES

Booth 515 / Circle 197

The Marco Weather-Tite System consists of innovative roof ventilation products and quality accessories for the metal roofing industry. For more than two decades, Marco products and services have focused on providing customers "Value Through the Roof". From the award-winning LP2 Ridge Vent to Flex-O-Vent rolls, durable closure materials, superior metal roof sealant, underlayment products, pipe flashings, clips, fasteners and outstanding warranties and service, Marco can be counted on for convenient solutions, industry expertise and outstanding service throughout North America.



RICHLAND
LAMINATED COLUMNS LLC

"Your One Stop Pole Shop"

**Distributor of Sturdi Wall
and Sturdi Wall Plus Brackets**

**Manufacturer of Quality Laminated
Columns and Richland Perma-Columns**

**3-Ply, 4-Ply, 2+6, 2+8
100% Treated or Non Treated**

Superior Treatment • #1SYP Lumber

• 30% Stronger than 6x6 solid

8252 Greenwich, Ohio 44837

Call Today for Nearest Distributor, Wholesale Only

Phone: 419-895-0036 FAX: 419-895-0062



Thank you for another successful year!

expo exhibitors

BY RURAL BUILDER STAFF



MARION MANUFACTURING INC.

Booth 708 / Circle 198

Marion Manufacturing adds the value to the metal! It designs, fabricates and installs custom manufacturing and production machinery. Marion Manufacturing specializes in metal forming equipment such as: roll formers, uncoilers, shears, stackers, etc. It also offers a full-service machine shop and re-tooling and service on other brands of equipment.

MARTIN BUILDING PRODUCTS

Booth 606 / Circle 199

Martin Building Products is a master distributor of reflective insulation, representing companies that supply the highest

quality products in the industry. Martin sells to post-frame and red iron building distributors of all sizes who are promoting the growth of the metal building and the metal roofing industries. Martin Building Products is independently owned.



MAZE NAILS CO.

Booth 200 / Circle 200

Maze Nails is the exclusive manufacturer of Stormguard double hot-dipped galvanized nails with a lifetime warranty against rust. In business since 1848, Maze offers a

full line of specialty nails in bulk for hand driving and in collated sticks and coils for popular pneumatic nailers. Maze has been serving the post-frame industry for many years, providing painted rubber washer nails for corrugated roofing and siding. Maze post-frame nails meet ASTM F 1667 specification. In addition, Maze manufactures nails for fiber cement siding products, cedar and redwood sidings, fencing, decking and roofing. Customers have come to identify Maze Nails with top-quality products, excellent customer service and quick, dependable shipments. Help hammer out foreign competition one nail at a time and bring jobs back to America. All Maze Nails are proudly 100 percent made in the USA.

MCELROY METAL

Booth 407 / Circle 201

Designed for post-frame and residential applications, the Mesa panel is a patent- and copyright-protected panel with a nearly invisible lap. The Mesa panel is sure to add beauty to any project, measuring 36 inches

BIG RED III

Make Your Own Nail-Lam Column



SEE THE ACTION

Total Fabricating System

www.semmlerinc.com

- Contains 10,000 nails in one load
- Total inline fabricating equipment: planner, conveyor, stacking cart
- Finger joint equipment options
- Requires only one fabricator
- Column engineering and design
- Fabricates 3 ply, 4 ply, 2x6 and 2x8 columns

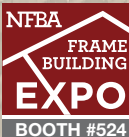

SEMMLER SYSTEMS INC.

Column Fab. Equip. Leader

Ph: 605-787-4765

Email: jimsemmler1@msn.com

Circle Reader Service #454

S-5!® Snow Retention

When snow begins to melt, the result can be catastrophic.

As the blanket of snow avalanches off the roof, it can dump several tons of snow onto anything in its path, damaging landscape, gutters, adjacent roofs, vehicles, and causing injury, or even death, to passers-by. These scenarios are preventable with top-of-the-line snow retention solutions by S-5!®



ColorGard®

Fitted with a strip of the roof material, ColorGard ensures a perfect color-match for the life of the roof.



SnoRail™ & SnoFence™

With up to six times the strength of adhesively-mounted devices, these systems offer a long-term, dependable solution for traditional standing seam and sheet copper roofing.



X-Gard™ — The NEW ultimate pipe snow retention system.

No other pipe snow retention system on the market has proven stronger than X-Gard.

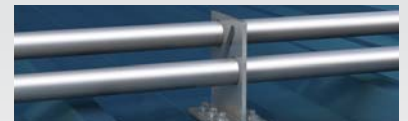

VersaGard™

VersaGard™ is compatible with almost any trapezoidal, exposed-fastened profile. No messy sealants to apply! No chance for leaks!

Connect with us!



@S5_TheRightWay



/S5TheRightWay

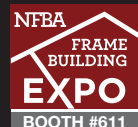

To learn more, call 888-825-3432 or visit www.S-5.com

Circle Reader Service #450

wide with ribs 3/4-inch high. McElroy Metal, a leading supplier of metal wall and roofing products to the post-frame industry, is a participating supporter of the National Frame Building Association. McElroy Metal is also a 33-time winner of the *Rural Builder* Gold Key of Excellence, as selected by readers.

MENARDS

Booth 201 / Circle 202

Menards began as a seller and builder of pole barns more than 55 years ago. Today it is the largest manufacturer and supplier of post-frame materials and services. The broadest selection of trusses, unparalleled steel panels and numerous trim shapes are in stock as well as custom trim made to your specs, laminated columns and much more. The most complete design, engineering, technical drawings, presentation drawings and estimating services are available.

METAL ROLLFORMING SYSTEMS

Booth 312 / Circle 203

Metal Rollforming Systems designs and



manufactures industry-leading roll forming equipment and accessories. MRS offers complete in-house design and manufacturing, allowing for competitive pricing and making MRS a leader in roll-forming equipment manufacturing. MRS's product lines consist of single- and double-deck roll formers, single and multi-trim roll formers, slitters and much more. MRS takes great pride in customer support both before and after the sale.

**METAL SALES
MANUFACTURING CORP.**

Booth 521 / Circle 204

Metal Sales offers a complete line of

metal roof, wall and fascia panel systems for the agricultural, suburban, residential and commercial markets. Celebrating 53 years of service in 2016, Metal Sales has the expertise to service post-frame builders and their customers' needs in new construction, expansion and retrofit.

METRO ROOF PRODUCTS

Booth 736 / Circle 205

Metro's lightweight (1.5 pounds per square foot) stone-coated steel roof systems come in five profiles, providing the right look for any architectural style. MetroShingle delivers the look of asphalt laminates, while MetroRoman, MetroTile and MetroShake create a traditional clay tile or hand-split wood shake impression without the weight and fire danger, and MetroCottage Shingle, with its multi-color shading suits any home. All Metro products are backed by a 50-year limited warranty covering 120-mph winds, Class-4 hail resistance and a 25-year limited appearance warranty.



Serving you since 1958



Give *Beauty* a whole new meaning with
Glue-Laminated *Arches, Beams, Posts, Bridges,*
and *Timber Trusses* - *Contact us today!*

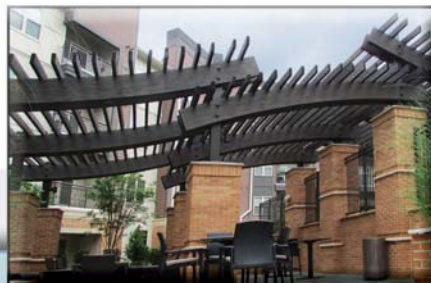

701 E. Linden Street Richland, PA 17087

Ph: (717) 866-6581 - Fx: (717) 866-7237

www.rigidply.com

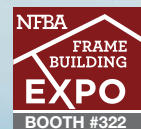

expo exhibitors

BY RURAL BUILDER STAFF

MIDWEST COLUMNS

Booth 145 / Circle 206

The mission of Midwest Columns is to construct the best quality laminated column in the Midwest at a competitive price. The company achieves this mission by employing only team members that pay close attention to detail and take pride in their craftsmanship while maintaining a good relationship with suppliers. The goal is to be a nationally-recognized brand in the post-frame industry by using the latest technology in column fabrication as well as dedication to the industry and its customers.

MILL STEEL CO.

Booth 639 / Circle 207

Now in its 57th year in business, Mill Steel is more dedicated than ever to its history of innovation and people-first culture that has made it one of the largest flat-rolled steel service centers in North America. Comprised of 12 production lines and four locations in Grand Rapids, Michigan; Detroit; Birmingham, Alabama; and a brand new facility in Jeffersonville, Indiana, Mill Steel guarantees quick turnarounds of

pre-painted or bare steel for customized color match. Mill Steel proudly offers AkzoNobel and Valspar color systems.

MSW CANADIAN PLASTICS

Booth 712 / Circle 208

MSW Canadian Plastics Inc. is a leading profile extrusion company based in Palmerston, Ontario, Canada. It strives to produce high quality products that provide PVC liner panel and partition solutions to its customers. MSW believes that quality and customer service are the first priorities. Products the company manufactures include Trusscore, Ribcore and Norlock. It also offers custom extrusion. It has distribution partners across North America and also ships product to many countries around the world.

MWI COMPONENTS

Booth 321 / Circle 209

MWI Components is a leading manufacturer and supplier of products for the post-frame industry. Celebrating 31 years of business in 2016, MWI Components offers



more color options for metal buildings than anyone in the industry. With more than 100 colors available in steel, almost 40 colors in aluminum and 50-plus powder coat colors, the combinations are endless. This allows builders and their customers to create beautiful and unique buildings using MWI cupolas, Ridg-Vents, soffit and trim, Dutch doors and bale doors, Arcadian sliding doors and stall systems.

Precoat Metals

Since 1959

New ideas and innovative solutions for over 50 years.

NFBA FRAME BUILDING EXPO BOOTH #616

314.436.7010 **Precoat Metals**

1310 Papin Street St. Louis, MO 63103 www.PrecoatMetals.com

Circle Reader Service #399

Royal Crowne Cupolas

ROYAL CROWNE OUTDOOR ACCENTS

717-355-2254

120MPH WINDS!

- * 120 mph Wind Rated
- * Easy installation
- * Sizes 24" - 72"
- * Square or Octagon
- * Louvers or Windows
- * Weathervanes

NFBA FRAME BUILDING EXPO BOOTH #711

www.royalcrownecupolas.com

Circle Reader Service #426

expo exhibitors

BY RURAL BUILDER STAFF

NATIONAL FRAME BUILDING ASSOCIATION

Booth 546 / Circle 210

The NFBA is the only national trade association that represents post-frame industry professionals. The association is the country's primary source of post-frame building resources, research, networking, news and education. Stop by the booth to learn more.

NATIONAL HARDWARE

Booth 121 / Circle 211

National Manufacturing Co. was started in 1901 as a small wagon company in Sterling, Illinois. The focus soon turned to manufacturing and selling general hardware. Over the course of the next century, National Hardware grew to be one of the leaders in builders' hardware. Today, the National Hardware brand has reached global status and offers more than 7,500 products. Its focus is on providing the best hardware and service to its valued customers.

NEW PROCESS STEEL LP

Booth 240 / Circle 212

This Indiana-based multi-divisional steel service center specializes in flat-rolled carbon products, including all materials needed in the frame-building industry for panels and roofing. New Process has coil in galvanized, Galvalume and pre-painted materials. Several paint systems are available as well as custom painting through regional roll coaters.

NOFP INC.

Booth 336 / Circle 213

NOFP manufactures high performance reflective foil insulation and under-concrete insulation for commercial, agricultural and residential construction. The BarrierX5 under-concrete insulation is 1-1/4 inches thick and comes in a 4x60 foot roll of flexible EPS foam used for radiant heated floor and goes directly on the grade. It meets the R-5 insulation requirement for most radiant floor installations. It's a great replacement for rigid sheet insulation because it is flexible and won't break when walked on. In addition, it has poly film layers laminated to the top and bottom so it doubles as a vapor retarder.

NORTH STAR METALS MFG. CO.

Booth 615 / Circle 214

Established in 1994, North Star man-

ufactures metal roofing, siding, custom components and assemblies for agricultural, architectural, industrial and residential markets. North Star utilizes state-of-the-art roll forming and folding equipment to produce consistently top-quality panels and trims exactly to order. A large selection of roll-formed panel and trim is available and CNC folding capabilities allow North Star to satisfy any custom panel or trim requirements, including matching discontinued and hard-to-find panels. North Star also offers on-site delivery with moffett-equipped tractor-trailer unit and roll-off capable gooseneck trailers.

NOVAGARD SOLUTIONS

Booth 518 / Circle 215

Novaflex metal roof sealant is one of the premier silicone sealants around, with its excellent adhesion to all metal types including Kynar, and its permanent flexibility. Novaflex extrudes down to -20° F and up to 120° F, and is tack free in 10-15 minutes. The seal stays flexible for years with minimal shrinkage, so there is no sagging, slumping or cracking. Look no further than Novaflex Metal Roof Sealant when you want the seal to last.



OHIO TIMBERLAND PRODUCTS INC.

Booth 505 / Circle 216

Ohio Timberland Products has long been considered the pioneering leader of nail-laminated column manufacturing and supply. It is flattered that while a number of suppliers have emerged over the years copying its design, Ohio Timberland remains true to the engineering principals involved with column production. Ohio Timberland's Christ-centered mission remains the same—to provide the post-frame community with the best quality nail-laminated columns delivered in a timely and economical fashion.

ONDULINE NORTH AMERICA INC.

Booth 716 / Circle 217

Onduline North America manufactures Tuftex building panels. Poly-Lite skylight/sidelight panels bring natural light into buildings. The Poly-Lite comes in 9- and 12-inch profiles, 38 inches wide, in smoke, clear or white. Tuftex PVC ag-liner panels, for lining the walls and

When **Quality Matters**
SELECT THE
BEST

SNOW RETENTION SYSTEMS

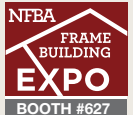

Snow
DEFENDER™
4500

METAL TO WOOD FASTENERS



Fastgrip™



METAL ROOFING ACCESSORIES



on over **1,600** Metal Roofing
Accessories and Fasteners

LEVI'S™
BUILDING COMPONENTS

Call for a FREE Catalog!
(877) 897-7020

www.levisbuildingcomponents.com



Looking for more information from companies featured in this issue?

Use the Reader Service card facing this page to get **FREE** information from our advertisers!

Free online info at www.bit.ly/info-rbfn

ADVERTISERS

RS #	Company	Page #	RS #	Company	Page #	RS #	Company	Page #
334	A J Manufacturing, Inc.	30	433	Graber Post Buildings	35	399	Precoat Metals	48
291	AB Martin	5	473	Henkel Corporation	32,33	503	Replications Unlimited	51
524	AG-Co Inc.	34	536	Hershey's Metal Meister	61	440	Richland Laminated Columns	45
481	Alpine Distribution LLC	14	469	Lakeside Construction Fasteners	38	426	Ridge Craft	48
317	Alpine Snowguards	24	341	Leland Industries	39	382	Rigidply Rafters	47
328	Atlas Bolt & Screw	34	392	Levi's Building Components	49	450	S-5!	46
441	Aztec Washer Co.	36	412	MFM Building Products Corp.	55	414	Schweiss Doors	28,66
338	Becker Specialty Corp.	54	308	MWI Components	15	429	Sealtite Building Fasteners	31
	Bradbury Group, The	66		Marion Manufacturing	66	454	Semmler Systems, Inc.	46
553	CHI Overhead Doors	36	306	Maze Nails Company	17	482	Sno Gem, Inc.	53
386	Cannonball:HNP, LLC	7	422	McElroy Metal, Inc.	58	540	Spectrum Brands HHI	21
315	Champion Steel Buildings	37	584	Metal Rollforming Systems	42	375	Starwood Rafters, Inc.	4
	Clark Industries	66	331	Metalcon	25	557	Stiletto Tools	53
581	Dura Coat	9	378	National Frame Building Assn.	19,27	425	Triangle Fastener Corp.	56
316	Dynamic Fastener	11	463	Nationwide Protective		564	United Steel Supply	57
319	ESP Inc.	38		Coating Mfrs., Inc.	41	301	VP Buildings, Inc.	4
407	Everlast Roofing, Inc.	68	533	New Process Steel Corporation	60	484	Valspar Corporation	23
	Extrutech Plastics	66	290	Novagard Solutions	42	374	Western Products of Indiana	6
359	Fasco America	37	516	Paint Valley Parts, LTD	44	511	Wick Buildings	59
384	Filc USA, LLC	13	350	Palram Americas	43			
464	Garwood Manufacturing Company	67	313	Plyco Corporation	2			

STORY RESOURCES

RS #	Company	Page #	RS #	Company	Page #	RS #	Company	Page #
TOP PRODUCTS OF 2015			116	A.B. Martin Roofing	20	EXPO EXHIBITOR PROFILES:		
101	MWI Components	16	117	Aztec Washer Co.	20	135	3GM Steel	29
102	Plyco	16	NEW PRODUCTS AT THE EXPO			136	A.B. Martin Roofing Supply	29
103	Dynamic Fastener	16	109	CannonBall:HNP	22	137	A.J. Manufacturing	29
104	Triangle Fastener	18	122	Boral	22	138	Akzo Nobel	29
105	Graber Post Buildings	18	123	Triangle Fastener	24	139	American Building Components	30
106	Palram Americas	18	124	Everlast Roofing	24	140	Anco Products	30
107	A.J. Manufacturing	18	125	Shear-X	26	141	Applicad-USA	30
108	The Brut Post Grabber	20	126	Maze Nails	26	142	Arch Wood Protection	30
109	CannonBall:HNP	20	127	Schweiss Doors	26	143	ASC Machine Tools	30
110	Alpine Snow Guards	20	128	Sealtite	28	144	Atlas Bolt & Screw	31
TOP EPRODUCTS OF 2015			129	Trussmate	28	145	Bay Insulation Systems	31
115	Extrutech Plastics	20	130	McElroy Metal	28	146	The Beckers Group	31
						147	Best Line Building Products	31

RS #	Company	Page #	RS #	Company	Page #	RS #	Company	Page #
148	Best Products	31	186	Indiana Warm Floors	42	223	Planet Saver Industries	52
149	Boral	34	187	Isaiah Industries	42	224	Plasti-Sleeve/Homework Design	52
150	Borkholder Buildings and Supply	34	188	Janus International	42	225	Plyco Corporation	52
151	The Bradbury Group	35	258	K&K Industries	43	226	Post Protector Inc.	53
152	The Brut Post Grabber	35	189	Kenwood Painted Metals	43	227	Power Lift Hydraulic Door	53
153	Burrow's Post Frame Supply	35	190	Kloekner Metal Building Products	43	228	PPG Industries	53
154	CannonBall:HNP	36	191	Lakeside Building Fasteners	44	229	Precoat Metals	54
155	Capital Forest Products	36	192	Leland Industries	44	230	Progressive Metals	54
156	Carter Lumber	36	193	Lester Building Systems	44	231	Radiant Outfitters	54
157	Central States Manufacturing	36	194	Levi's Building Components	44	232	Richland Laminated Columns	54
158	C.H.I. Overhead Doors	36	195	Liberty Steel Products	45	233	Ridge Craft LLC	54
159	Cidan Machinery	37	196	MAC Metal	45	234	Rigidply Rafters	55
160	Clark Industries	37	197	Marco Industries	45	235	RL Adams Plastics	55
161	Direct Metals	37	198	Marion Manufacturing	46	236	S-5!	55
162	DL Truss/Structural Glulam LLC	37	199	Martin Building Products	46	237	Safe-Way Garage Door	55
163	Dura Coat Products	37	200	Maze Nails	46	238	Schweiss Doors	56
164	Dynamic Fastener	38	201	McElroy Metal	46	239	Sealtite Building Fasteners	56
165	Eagle Metal Products	38	202	Menards	47	240	Semmler Systems	56
166	East Coast Fasteners	38	203	Metal Rollforming Systems	47	241	SFS intec	56
167	Energy Panel Structures	39	204	Metal Sales Manufacturing	47	242	Shear-X	57
168	Entrematic/Amarr	39	205	Metro Roofing Products	47	243	Sno Gem	57
169	Environmentally Safe Products	39	206	Midwest Columns	48	244	Steel Dynamics	57
170	Everlast Roofing Inc.	39	207	Mill Steel	48	245	Stiletto Tools	57
171	Extrutech Plastics	40	208	MSW Canadian Plastic	48	246	Swenson Shear	59
172	Fabral	40	209	MWI Components	48	247	Symun Systems/ Construction Maestro	59
173	Fasco America	40	210	National Frame Building Assoc.	49	248	Taylor Steel	59
174	Fasteners Direct	40	211	National Hardware	49	249	Timber Tech Engineering	59
175	Filc USA	40	212	New Process Steel Corp.	49	250	Triangle Fastener Corp.	59
176	FootingPads & Cupolas by Ag-Co	40	213	NOFP	49	251	Triton Barns	60
177	Frame Building News	40	214	North Star Metals Mfg.	49	252	Trussmate	60
178	Free State Lumber Co.	40	215	Novagard Solutions	49	253	United Steel Supply	60
179	Graber Post Buildings	40	216	Ohio Timberland Products	49	254	Valley Lumber Co.	60
180	H&H Metal Products	41	217	Onduline North America	49	255	Valspar	60
181	Hershey's Metal Meister	41	218	OSI Adhesives & Sealants	52	256	Western Products Of Indiana	61
182	Hiab USA	41	219	Paint Valley Parts/Acu-Form	52	257	Wick Buildings	61
183	Hoover Treated Wood Products	41	220	Palram Americas	52			
184	Hörmann LLC	41	221	Paramount Metals	52			
185	I-Beam Sliding Doors	42	222	Perma-Column	52			

PRE-ENGINEERED FAUX STONE PANELS

for more info and samples contact us at 314-524-2040

4 Styles & multiple colors available

- Single piece 8 foot long wainscot stone panels with built-in ledger
- Lightweight System - no footing or support beam required
- Simple low cost installation
- High quality coloring, depth and appearance
- Matching column kits available
- High R-Value (5-6)
- Low maintenance

www.urestonepanels.com

Circle Reader Service #503

BY RURAL BUILDER STAFF

ceilings of agricultural structures come in corrugated 9-inch profiles, 38 Inches wide, in black or white.

OSI ADHESIVES & SEALANTS

Booth 739 / Circle 218

Tradesmen who sought better performance from adhesives and sealants on the job site founded OSI in 1966. Acquired by Henkel Corporation in 2004, OSI Adhesives and Sealants combines tough real-world job site experience and a deep understanding of the trades with the sophisticated global innovation and manufacturing excellence of Henkel Professional and Consumer Adhesives. Visit the Expo for more information about OSI's QUAD MAX.

PAINT VALLEY PARTS LTD./

ACU-FORM

Booth 724 / Circle 219

Acu-Form, a division of Paint Valley Parts, is a manufacturer of metal forming equipment such as the ag panel, stretch wrapper, corner, post cut shear, hemmer, slitter, J-channel, rat guard, uncoiler, table and roll, ridge cap and more for commercial and residential construction use. The company's goal is to meet and exceed customer expectations. The No. 1 priority is to send customers a durable, top-performing machine that will give years of trouble-free service. Acu-Form uses D2 tool steel as a standard.

PALRAM AMERICAS

Booth 633 / Circle 220

Palram continues to expand its SunSky polycarbonate panel line, allowing builders to offer more day lighting and side light-

ing options to customers. With Palram's MetalMatch Technology, it can match virtually any corrugated metal panel profile available with minimal order requirements. Palram also offers a complete line of Ag-Tuf PVC liner panels for interior and exterior use.

PARAMOUNT METALS

Booth 126 / Circle 221 /

Paramount Metals provides 29- and 26-gauge Grade D and E coils to metal building manufacturers in the U.S. and Canada. Paramount's goal is to provide service and guidance to help businesses grow. Paramount stocks a full line of coil inventory including 20-inch standing seam coils. Paramount is better able to control delivery by using its own trucks and has the ability to provide several common trims and trim flat sheets.



PERMA-COLUMN INC.

Booth 411 / Circle 222

Perma-Columns are 5-foot precast concrete columns that keep wood out of the ground, ensuring your building's foundation will never rot. They are the first product to combine the economy of post-frame construction with the durability of a concrete foundation.

PLANET SAVER INDUSTRIES LLC

Booth 603 / Circle 223

GreenPost from Planet Saver Industries offers a unique non-toxic concept for protecting in-ground wood from the harmful effects of ground contact decay, at the same time providing uplift restraint. GreenPost is laboratory proven, termite tested and building-code compliant and is applied to posts using a specialized production machine so posts arrive ready for installation. GreenPost also complements pressure-treated posts by providing an environmentally friendly barrier, helping to keep the preservatives in the post longer.



PLASTI-SLEEVE/ HOMEWORK DESIGN INC.

Booth 211 / Circle 224

With 20 years in production, the original Plasti-Sleeve is the leader in post protection for buildings, offering economical, versatile and easy slide-on installation for 20 different post sizes. Made in the USA from the highest quality black HDPE plastic, Plasti-Sleeve offers unparalleled in-ground durability. Also available is Plasti-Skirt, an economical, easy to use, Plastic Skirt Board Protector, available for 2x8 and 2x6 skirt boards.



Palram Americas

PLYCO CORPORATION

Booth 301 / Circle 225

Plyco manufactures the most durable and dependable building components for the post-frame, metal building, commercial and light-commercial industries. Strength means long-lasting toughness, quality, performance and aesthetics for contractors and building owners. Plyco's full line of walk doors and windows are engineered to meet today's building codes. From commercial to agricultural to outbuildings Plyco manufactures quality products to fit your construction needs. Contractors across North America trust Plyco's full line of track, SDR,



POST PROTECTOR

Booth 423 / Circle 226

Post Protector is a slide-on barrier system, delivering serious post decay protection. Post Protector tackles post longevity concerns by eliminating both soil/concrete-to-post contact and chemical migration. Post Protector retains the simplicity, affordability, speed and strength of typical post-in-ground construction techniques. Horizontal perimeter ribs, in conjunction with provided hardware yield substantial post uplift protection and best of all, installation is a snap. It's simple: by keeping soil out and treatment in, Post Protector dramatically improves post-frame foundations.

ridge vents, cupolas, slide doors, Dutch doors, Champion doors, Equus products and Ply-Foil. One company for durable and reliable building components makes Plyco the easy choice for contractors.

POWERLIFT HYDRAULIC DOORS

Booth 339 / Circle 227

Only PowerLift has built hydraulic doors continuously since 1992. Only PowerLift supports you with local man-



ufacturing, sales and service. And only PowerLift installs every door, making your project simple and hassle free.

PPG INDUSTRIES

Booth 223 / Circle 228

PPG metal coatings balance the performance and budget demands of building product manufacturers, building owners and architects. DuraStar SMP (silicone-modified-polyester) and DuraForm next-generation polyester coatings deliver long-lasting, value-oriented color and protection for metal panels, roofs, door frames, garage doors and

STILETTO

TITANIUM TOOLS

NEW!
STAINLESS STEEL
Nail Puller & Prybar

TiBone 15 milled/curved

12" Stainless ClawBar w/ Dimpler

15" Stainless Flatbar w/ staple puller

10X LESS RECOIL
HALF THE WEIGHT
MORE PRODUCTIVITY

NFBA
FRAME BUILDING
EXPO
BOOTH #236

www.stiletto.com (800) 987-1849

Circle Reader Service #557

NFBA
FRAME BUILDING
EXPO
BOOTH # 215

SNO GEM
The Ultimate in Snow Retention

SNOGEM.COM 888-SNO-GEMS

Circle Reader Service #482

expo exhibitors

BY RURAL BUILDER STAFF

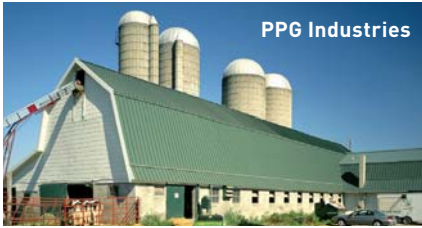

more. Duranar fluoropolymer coatings, including IR-reflective Duranar Ultra-Cool and Varo-Cool coatings, provide exceptional performance for high-end wall panels and roofing applications, even in harsh sea coast, desert or industrial environments.

PRECOAT METALS

Booth 616 / Circle 229

You name it, Precoat Metals can process it. With 13 plants strategically placed, the ability to coat up to 72 inches wide and an extensive line of processing capabilities, Precoat Metals has positioned itself as an industry leader. From its outstanding customer service, to its attention to detail they've got you covered. Precoat Metals is your one-stop shop for coil coating needs. Visit the Expo booth to view the company's innovative products.

PROGRESSIVE METALS

Booth 439 / Circle 230

Progressive Metals aims to meet and exceed all customer coil needs. Offering high-quality metal in many colors, excellent service and exceptional delivery will put Progressive Metals on the top of your list as the choice for all your metal roofing options.

RADIANT OUTFITTERS

Booth 715 / Circle 231

Radiant Outfitters specializes in hydronic radiant floor heat. Radiant floor is a popular option for post-frame builders. Radiant Outfitters takes the guesswork out of floor heat for building contractors. Radiant Outfitters offers very unique tubing that has 20 percent better heat transfer and the highest pressure and temperature ratings on the market. Add floor heat to your offering and add to your profits.



RICHLAND LAMINATED COLUMNS LLC

Booth 417 / Circle 232

Laminated columns are an industry standard and Richland Laminated Columns continues to offer post-frame builders an increasing range of products. In 2010, it acquired the rights to manufacture and distribute Perma-Column. Combined with Sturdi-Wall brackets, FootingPad by Ag-Co and the Post Protector, the customer now has access to a full range of post protection products.

RIDGE CRAFT LLC

Booth 711 / Circle 233

Royal Crowne Cupolas are manufactured by Ridge Craft, which features one of

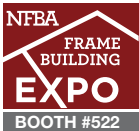

BeckryTex

NEW TEXTURED PAINT SYSTEM



Architectural low gloss anti-reflective coating

BeckryTex technology allows you to design unique and distinctive exterior textured finishes. A flexible, low gloss polyurethane coating, it is most often used on roofing for a well defined wrinkled look that creates the appearance of materials other than metal. A wide range of popular colors are available in this weather resistant product.

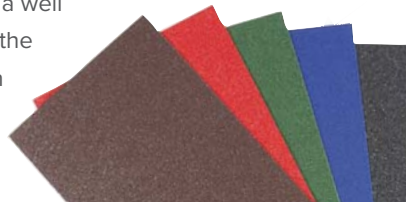

Beyond The Surface

Becker Specialty Corporation

2526 Delta Lane, www.beckers-group.com
Elk Grove, IL 60007 rob.roy@beckers-group.com
P: (847)766-3555
TF: (800)782-2400

Circle Reader Service #338



the most extensive lines of cupolas in the industry, including a line specific for the post-frame industry. These cupolas range in size from 24 to 72 inches, in square and octagonal configurations and available with louvers or windows. These cupolas can be made to match most metal colors. Ridge Craft also has a large selection of vinyl, cedar and copper cupolas.

RIGIDPLY RAFTERS INC.

Booth 322 / Circle 234

Rigidply Rafters has improved the quality of post-frame buildings by manufacturing and distributing the original 100 percent glue-laminated post. By specifying Rigidply Posts, you guarantee the labor-saving and quality advantages of true glulam posts. Not only are glulam posts lighter, straighter and stronger than solid sawn posts, but they minimize cracking and splitting. When planning your next building project, count on Rigidply Rafters to supply integrity, quality and service with your glulam posts.

RL ADAMS PLASTICS INC.

Booth 601 / Circle 235

RL Adams Plastics Inc. produces state-of-the-art foam products for both commercial and residential use. RL Adams specializes in the production of extruded polystyrene (XPS), thermoforming XPS, and laminating XPS with a variety of facer materials.

S-5!

Booth 611 / Circle 236

S-5! products attach ancillaries securely to almost any metal roof profile, including exposed-fastened and corrugated. Brackets boast unprecedented holding strength, making them ideal for heavy-duty applications such as the S-5! ColorGard snow retention system. The latest innovation in an expanding line of brackets is the versatile ProteaBracket, designed to fit any trapezoidal sheet shape. ProteaBracket is ideal for medium-duty applications and is compatible with the S-5 PV Kit for mounting and bonding solar panels.

SAFE-WAY DOOR

Booth 202 / Circle 237

Safe-Way Door is a leading manufacturer of quality residential, commercial,

and industrial overhead garage doors in steel, wood and aluminum. Headquartered in Warsaw, Indiana, Safe-Way Door also operates facilities in Tennessee and Missouri with distribution throughout North America. Doors are available in multiple configurations including insulated, uninsulated and up to eight col-



Safe-Way Door

PEEL IT. SEAL IT. DONE!

PEEL & SEAL®

SELF-STICK ROLL ROOFING

Peel & Seal® is the original self-adhering waterproofing membrane designed for low slope roofing or flashing applications. This single-ply membrane applies directly to the roof deck and serves as the final roofing surface. Ideal for hundreds of applications including whole roofs, dormers, sunrooms, metal roofs, and flashing around exterior penetrations.

mfm

BUILDING PRODUCTS CORP.

800-882-7663 | www.mfmbp.com

- Ideal for difficult roofing applications
- Aggressively adheres to the roof deck
- Self-seals around fasteners
- Aluminized surface limits solar gain
- Easy handling and installation
- Requires no coatings or coverings for permanent exposure to sunlight
- Virtually maintenance-free
- Variety of widths and color options
- 10-year limited warranty
- Made in the USA

expo exhibitors

BY RURAL BUILDER STAFF



ors depending on the model. Commercial door sizes are available in all of the panel designs. Safe-Way also sells Lift-Master openers and carries other accessories.

SCHWEISS DOORS

Booth 728 / Circle 238

Schweiss Doors has been a leading man-

ufacturer of hydraulic one-piece doors and patented Lift Strap/Autolatch bifold doors for more than 35 years. Renowned for its quality craftsmanship, Schweiss' custom-made engineered doors are specially designed for many applications, including commercial, industrial, agricultural, residential, hangars and designer doors. A Schweiss rep will demonstrate working models of both style doors at the Frame Building Expo.

SEALTITE BUILDING FASTENERS

Booth 511 / Circle 239

Sealtite manufactures and supplies steel-frame and post-frame screws for commercial, industrial, agricultural and residential metal roofing applications. Product strengths are drill quality and corrosion resistance, showcased on the MAXX Steelbinder and on the KwikSeal Woodbinder with micro-bit technology. New in 2016, this new point will be the most consistent available today, and eliminates slow drilling or no drilling sharp point screws. All metal-to-wood screws will be available with this new point, including the ZXL Woodbinder zinc-aluminum alloy head for roof systems requiring a 40 year warranty. Solid and vented foam closures, pipe flashings, pancake- and wafer-head screws for standing seam roofs round out the product line.

SEMMLER SYSTEMS INC.

Booth 524 / Circle 240

Big Red 111, Semmler's newest model for fabricating wood laminating columns features a design that contains 10,000 nails in one loading. Special design of in-line equipment best saves plant layout space and requires only one operator for the total system. Total system equipment includes the Big Red fabricator, conveyor system, gusset press, planer with chip collector, bunk-stacking cart with flanged wheels and track. Now available is the finger joint system that features unique finger joint detail. Available with jib crane with vacuum lift and scissor lift.

SFS INTEC

Booth 421 / Circle 241

SFS intec is a premier manufacturer of metal panel attachment fasteners for the metal building and post-frame markets. Fasteners include #9 woodGrips, #10 HiLo woodGrip with mill point and the #12 wood-Grip XG with a large aggressive thread design for superior performance in OSB and ply-



FASTENERS TOOLS SEALANTS ACCESSORIES

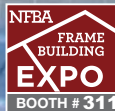

800.486.1832

Serving you since 1977, in 23 Locations Nationwide

Check out our new website for the most up-to-date products!

www.trianglefastener.com

Proud member of...



Circle Reader Service #425

wood. Long-life fasteners include the everGrip bi-metal, woodZAC alloy cap and woodMAC SS capped fasteners. SFS intec is also now a distributor for S-51 clamps, brackets and snow retention products. Other accessories include panel clips, ProfileVent ridge ventilation, pipe flashing and WG-7 foam closure.

SHEAR-X

Booth 727 / Circle 242

Making its debut at the Frame Building Expo is the Shear-X by Garwood Manufacturing Inc., the first of its kind stabilizer for continuous ridge vents. Use on any type of roof for continuous load transfer across the ridge. Nothing has ever provided this kind of seismic and wind stability. Shear-X allows the use of continuous ridge vents in both blocked or unblocked diaphragms and can be used on buildings with roof rafters 16- and 24-inches on center, and on both flat and pitched roofs 1:12 to 20:12. Take a closer look at this revolutionary new building technology.



SNO GEM INC.

Booth 215 / Circle 243

Sno Gem Inc. is the world-renowned leader in the manufacturing and distribution of innovative snow retention systems for all types of roofs. With more than 50 years of industry experience, every Sno Gem product is the latest in cutting-edge design and engineering technology. Offering polycarbonate, metal, non-penetrating “clamp to seam” or deck mount/membrane bar snow retention systems for metal, slate, shingle/tile and membrane roof systems in virtually any color, Sno Gem is your one source for effective and aesthetically-pleasing snow management systems.

STEEL DYNAMICS INC.

Booth 539 / Circle 244

Steel Dynamics is a leader in the production of high quality, low cost, pre-painted steel for the metal construction industry. Its wide-width, light-gauge pre-painted flat rolled steel is perfectly suited for roof, wall and fascia systems used in the construction of metal structures. Also, SDI’s prepaint lines run parallel to

its galvanized and Galvalume lines, reducing transportation costs and shortening the supply cycle, saving time and money.

STILETTO TOOLS

Booth 236 / Circle 245

Stiletto’s Titanium Ti-Bone hammer has become the tool of choice for professional post

beam and pole barn framers in the U.S. and Canada because the 20-, 30- and 60-penny spikes these builders use are hammer and elbow killers. Titanium offers 10 times more dampening of recoil shock than steel hammers and has an indefinite service life with its replaceable steel faces.

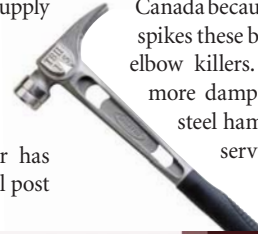

When you need steel,
you can count on us.

As the leading distributor of high quality flat rolled steel coils, you can count on United Steel Supply to offer competitive pricing, on-time delivery and superior customer service.

We furnish Galvalume®, galvanized, and prepainted coils for all metal roofing and siding applications. With a wide variety of stock colors and color-matching capabilities, you’re sure to find what you need with United Steel Supply.

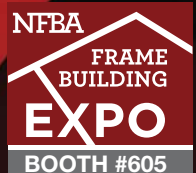

For more information, visit www.unitedsteelsupply.com or call 512-263-0954.

Because your customers deserve . . .

the Industry's Finest Metal Panel!

MESA



Tired of the industry's same old "Ag Panel" that has been used for decades *and* most all your competitors offer? Isn't it time for a change? MESA, by McElroy Metal, is a way to offer your customers a patent and copyright protected alternative that can't be duplicated! Featuring a . . .

- **Nearly Invisible Lap**
- **Galvalume® Substrate**
- **Kynar 500® Coating**
- **Edge Coating Rust Inhibitor**
- **.015 Minimum Thickness**



MESA is simply the industry's finest panel! Make MESA your competitive advantage!

*Please join us at the
NFBA Frame Building Expo*



**Booth #
407**

*50 years and Growing
Family Owned - Quality Focused*

For more information: 800-562-3576

www.mcelroymetal.com • info@mcelroymetal.com

Circle Reader Service #422



SWENSON SHEAR

Booth 207 / Circle 246

Swenson Shear has spent the last year revamping all product lines in order to continue to provide the highest quality metal panel preparation for concealed and exposed fastener panels, soffit and siding, and stone coated steel. The SnapTableHD adjusts to accommodate between 12- and 22-inch panels; and is equipped to notch, slit, and hem up to 33-inch offsets for hips and valleys. The SnaptablePRO is the newest addition to the line added to provide the capability to slit and hem up to 60 inches for any commercial, industrial, or residential job site.



SYMUN SYSTEMS INC./ CONSTRUCTION MAESTRO

Booth 204 / Circle 247

Construction Maestro from Symun Systems is known for its detail, accuracy and ease of use. It automates the process of generating all necessary field-ready plans and material lists within just a few minutes for a post-frame or stud-frame building.

TAYLOR STEEL INC.

Booth 334 / Circle 248

For more than 46 years, Taylor Steel has been supplying the building products and construction markets throughout North America. With an extensive inventory of bare and pre-painted coil and sheet, Taylor Steel offers a quick turnaround for your standard or custom-supply needs.

TIMBER TECH ENGINEERING INC.

Booth 206 / Circle 249

Timber Tech Engineering provides structural design of building components and complete building systems for post-frame and light wood constructed buildings. Timber Tech also offers structural design of foundation systems, roof systems, concrete, masonry and steel design. Engineer certifications are available for all 50 states and Canada. Designs are customized for each specific application. Timber Tech would enjoy the opportunity to review its services with you as well as show you some of its recently completed projects.

TRIANGLE FASTENER CORP.

Booth 311 / Circle 250

Triangle Fastener Corporation is a leading supplier of standard and specialty fasteners, tools, sealants and accessories for the commercial construction industry. A complete line of fasteners for metal-to-metal, metal-to-wood, drywall and concrete anchoring is available from each of its 23 locations. Triangle's "Need-It-Now! Program" is designed to provide fastening solutions for difficult applications. TFC has nine in-house painting facilities that can

expo exhibitors

BY RURAL BUILDER STAFF



Build with Confidence Build with Wick Buildings

Wick Buildings has been helping farmers, families and businesses by providing long-lasting, low-maintenance buildings since 1954.

Buildings with quality and value...and no compromises. Join our team!

800-356-9682
WickBuildings.com



Agriculture ■ Suburban ■ Equestrian ■ Commercial

Stop by our booth, #416, at the NFBA Frame Building Expo and enter to win a free \$400 Lowe's gift card!

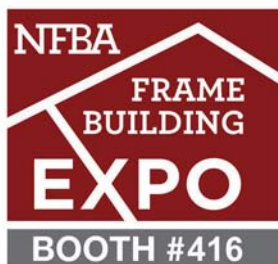

Circle Reader Service #511

expo exhibitors

BY RURAL BUILDER STAFF

custom color-match fasteners to exact requirements with delivery in three days or less. TFC offers job site assistance, technical assistance, Pak-One inventory management programs and product development. The TFC Market-Specific Catalogs, including the *Metal Roofing & Siding Catalog*, can be found on the company's website and are complete with products and technical information on a wide variety of fastening systems solutions.

TRITON BARN

Booth 133 / Circle 251

Triton Barns specializes in providing all of your stall or horse barn needs including standard horse stalls, portable facility horse stalls, custom Euro stall fronts, horse stall kits, modular horse barns, roofing, lighting and stall flooring. Triton offers horse barn and livestock pen product systems for fairgrounds and individual use. Products are hot-dip galvanized after fabrication and backed with a 25-year rust-free warranty. All Triton products are designed with the safety of both horse and owner in mind.

TRUSSMATE

Booth 242 / Circle 252

Trussmate is the easiest, fastest, most economical way to set trusses ever invented. It installs where you would normally use a temporary tie. It is economical because it is reusable and cuts down on labor costs. It is simple because it installs on the ground with



a 1-tack nail (not in the air while standing on webbing). It is safe because no men or equipment are needed in the webbing during initial installation of trusses. It is strong because it is made from solid aircraft aluminum. And it is accurate because it is notched for centerline measurement. Visit the Expo to take a closer look at this revolutionary new product.

UNITED STEEL SUPPLY

Booth 605 / Circle 253

United Steely Supply is a leading distributor of Galvalume, galvanized and pre-painted steel coils for metal roof and siding applications in the agricultural, commercial, industrial and residential markets. The company's products are made of the highest quality steel, allowing customers to maximize production efficiency and provide top quality material and efficient yield to final users. Visit the Expo to get a quote, make a purchase or hear what United can do for you.

VALLEY LUMBER CO. INC.

Booth 246 / Circle 254

Located in the beautiful Tennessee Valley, Valley Lumber Company Inc., is strategically placed to be your effective, efficient and dependable source for engineered wood products and Southern Yellow Pine. VLC manufactures Ultralam, the strongest specialty structural-framing column used in the post-frame building industry. It is the only glulam manufacturer nationwide that treats its own lumber. Also offered are preservative treatment of timbers, dimensional lumber, plywood, siding and fence posts and poles. With two on-site treatment facilities, a high-capacity dry kiln and two manufacturing plants, it is able to offer a wide variety of products. This large offering allows the company to specialize in mixed loads in an effort to save you time and freight costs.

VALSPAR

Booth 512 / Circle 255

For more than 200 years, Valspar has been a leader in the art and science of coatings that excel in both beauty and function. The expansive range of superior coatings comes to life through a full palette of colors and surface textures to meet the most demanding environmental conditions and designs. WeatherXL is the latest in cutting-edge coating formulation. It is recognized for its durability and offers even stronger protection against weathering and supe-

New Process Steel is the coated steel specialist shipping throughout the Midwest and South.

IF YOU NEED TRUCKLOAD QUANTITIES OF STEEL... WE CAN HELP!

Specializing in Post Frame Coils

- 29 gauge galvanized
- 26 and 29 gauge galvalume
- Combine colors for truckload quantities

See us at FBE Booth #240

NEW PROCESS STEEL
www.nps.cc

Butler, IN	Ph: 888-280-8018	ccurtis@nps.cc
Alsip, IL	Ph: 800-972-6772	tpartipilo@nps.cc
Birmingham, AL	Ph: 800-742-6992	bleahy@nps.cc
Columbus, MS	Ph: 888-280-8018	ccurtis@nps.cc

Circle Reader Service #533



rior scratch resistance, with the WeatherXL Crinkle Finish offering a unique texture finish. Ideal for commercial and residential metal roofing, agricultural and industrial buildings and metal wall panels, WeatherXL lives up to its reputation.



WESTERN PRODUCTS OF INDIANA

Booth 245 / Circle 256

With Western's extensive line of sliding door track, accessories, sliding door frames, equestrian products, walk doors, windows, polycarbonate skylights, foil insulation and much more, you're sure to find your product needs. Established in 1929, Western's reputation for quality, service, pricing and industry knowledge will help you build the future.



WICK BUILDINGS

Booth 416 / Circle 257

Wick Buildings is a leader in the post-frame industry founded in 1954, and now with more than 72,000 buildings completed. Wick builds everything—from industrial and light manufacturing facilities to banks and aviation buildings, from gas stations and churches to equine and livestock facilities, to storage facilities. When you choose to become a Wick builder you'll have a building partner with corporate strength and a name you and your customers can trust.



**A Unique Hybrid of European Design
& American Manufacturing**



SHEET METAL FOLDING MACHINES

We Start Here!



HEAVY DUTY

8" x 12" Frame Construction



SINGLE
& DOUBLE
BENDERS



NFBA
FRAME
BUILDING
EXPO
BOOTH # 735



HERSHEY'S

THE METAL MEISTER, LLC
420 PROGRESS DR. MATTOON, IL 61938
TOLL FREE: (877) 289-3030
INFO@HERSHEYSMM.COM



Call Today for More Information and Your Free Brochure! We are here to assist you!



Building the modern beef barn

ABOVE In the calf barn, Wieser met Eron's desired slat opening tolerances in the slatted concrete floor. This provides an adequate opening to allow manure to pass through yet also helps assure hoof safety for smaller cattle. The calf barn slat tolerances are 1-1/4 to 1-1/2 inches, while it is 1-1/2 to 2 inches in the beef barn.

RURAL BUILDER HAD THE OPPORTUNITY OF WATCHING THE BUILDING OF A MODERN BEEF BARN step-by-step from the ground up last summer, in fact two barns in the span of one year. It's uncommon because our offices are located in Central Wisconsin dairy country.

"I've been planning this for a lot of years," said the owner, farmer Dave Eron, Stevens Point. Starting out as farm renters, he and his

wife, Robyn, purchased their current farm, then just 240 acres, in 2008.

As a young farmer with a lot riding on his decisions, he wanted to make sure he got his money's worth with his new barns. He studied his options carefully, consulted with various engineers and spent hours just watching his herd of Holstein steers to determine how to raise contented, healthy cattle and consequently his own profits. Having

post-frame project

BY SHARON THATCHER



▲ Owner Dave Eron now operates Eron Beef LLC out of two new post-frame barns, both completed in 2015, near Stevens Point, Wisconsin. The calf barn is under construction in this photo. The finishing barn is to the right.

◀ Building the Eron beef barns became a family project when two of Dave's young sons, Sam, 11, and Charlie, 4, helped with the fun job of pounding 3,840 slat locks into the 767 slatted rubber floor mats. Dave and his wife now have a third son, Owen, born near completion of the calf barn.

building crews open to his requests, which he admits were at some times demanding, was paramount to the process. "I spent [a lot of time and money] up front to get what I wanted," he said.

Each of the two post-frame barns built by Forest Construction, Luxemburg, sit over 12-foot deep Pan-L-Bilt manure pits from Wieser Concrete Products Inc., Maiden Rock. Spiegelberg Implement, Weyauwega, provided custom work on the exterior walls and pen dividers, feed rails and gates. Eron served as his own engineer and excavator.

The larger of the two barns, 105x325 feet, was built first in the winter of 2014-2015 for finishing cattle. The smaller, 90x325 feet barn was built in 88 days over the summer of 2015 to house calves purchased at 350 pounds. Seven days after completion of the calf barn, the first shipment of calves arrived. The animals will spend about six months in each facility before heading to market.

Eron has been pleased with the results so far, with the first round of cattle requiring 10 percent less feed than his open-lot herd, and finishing for market sooner than expected. **RB**



▲ Corners at walk-throughs were rounded at Eron's request for cattle safety so cattle could be moved in and out of pens without injury or bruising.

▲ Wieser Bros. Concrete erected the pre-cast, 12-foot deep pit over a 6-inch poured Ready-Mix floor. Eron wanted drive-through feeding inside the barn, so extra posts and support beams in the pit allow for more strength above for heavy equipment.

► Dave Eron hasn't stopped watching his cows closely now that the barns are built and occupied, knowing that they will let him know what they need. An example: when the cattle started scratching themselves on the sidewall cable system, he bought them a back scratcher. Voila! "Now they don't rub themselves on the cable," he said.





◀ **FAR LEFT** Feeding is done inside the barn thanks to extra pillars built in the manure pit to allow for heavy traffic above.

◀ The last three bays of calf barn (36' X 90') are reserved for working facilities and an office and utility room.

▼ Cattle drinker pads and plumbing were constructed so as not to interfere with the pit below.



▲ Eron discovered that an open-ridge roof is an economical option for naturally vented, slatted floor livestock barns like his.

◀ In beef barns, where shorter-term housing results in fewer foot issues, aerobic pits have become popular. They are built under the barn like the Wieser pit. Eron's beef barn has a 3.2 million gallon capacity pit, which should give him about a year's worth of manure storage, while the calf barn has a 2.1 million gallon storage capacity. It will be slurried through agitation and then pumped out through a drag hose to Eron's surrounding 500-acre farmland.



▲ Bird deterrent design is at play throughout the two barns.

LISTENING TO THE CUSTOMER

Dave Eron said he was a demanding customer, but that's to be expected when your livelihood depends on the outcome. Both Wieser and Forest Construction spokesmen weigh in on the Eron Beef project and in general how they handle customer relations.

"One of our biggest reasons for being successful is because we listen to our customers and do everything we can to try and meet their needs. For example Dave had mentioned the square edges on our walk-through to the drover lane would be more animal friendly if they were rounded, so we changed the 90 degree corner to a miter corner. We also changed our load design for our drive-through to meet Dave's needs for his feeding-load capacity. These are just a few examples of what we do to try and give our customers the best product to fit their needs. Customer relations are very important in the success we've had in the industry."

— **DAN MCKINNEY**, PROJECT SUPERINTENDENT,
WIESER CONCRETE PRODUCTS INC.

"Farming... is definitely more sophisticated today. Farmers no longer have to be just farmers, they also have to be business managers.

"Also our projects have become focused more on improvements technologically, and along with that, the looks of the building. It is not just the functionality, it also has to look good.

"We are a custom builder so we will tailor the project according to the individual's need no matter how demanding that might be.

"Dave Eron knows exactly what he wants. Along the way we put it out that if we were doing anything aside from what he envisioned, to let us know and we would accommodate that."

— **AARON NIMMER**, FOREST CONSTRUCTION,
LUXEMBURG, WISCONSIN

classified ads

CALL 800-726-9966

140 BUILDING OPPORTUNITIES

WANTED:

INVESTOR/PARTNER/BUYER

Upscale Pole Barn builder in Eastern PA is experiencing very rapid sales growth. Current Yearly Revenue = \$10 mil
Over 35 successful years with continuing excellent margins.
Backlog has more than doubled and continues to grow.
Working capital requirements are exceeding our capacity.

Complete information for interested parties can be obtained from our consultant -- 484-645-4866 or rfedirka@fedirka.com

160 DOORS & WINDOWS

New One-Piece 800-746-8273

DOORS

- AG DOORS
- SHOP DOORS
- BARN DOORS
- AVIATION

Say YES... to Strap-Lift Doors
Say NO to Cable Lift

Booth #728

HYDRAULIC OR BIFOLD
"One-Piece" DOOR STRAP LIFT and auto latch

SCHWEISSDOORS.com

400 ROLL FORMERS



MARION MANUFACTURING

- Automation Systems
- Metal Construction Rollformers
- Coil Processing
- Forming & Fabrication
- Recondition Existing Machines

NFBA FRAME BUILDING EXPO BOOTH #708

WE ADD THE VALUE TO METAL

1-888-865-8740 www.marionmanufacturing.com

250 MISCELLANEOUS

Extrutech FORM™ System



Booth #307

Extrutech FORM™ System brings a bright new 6" thick by 24" inch wide face to stay-in-place concrete form construction by combining standard concrete form methods with the easy-to-clean, sanitary surface that Extrutech panels provide. Perfect for process area walls.

Suspended Ceiling Panels and Doors also Available



NEW PRODUCT

888-818-0118



www.epiastics.com
email: info@epiastics.com



Manufacturing American-Made PVC Panels for 22 Years!

EXTRUTECH PLASTICS, INC.

400 ROLL FORMERS



NFBA FRAME BUILDING EXPO BOOTH #527

BRADBURY
THE BRADBURY CO., INC.

We Build Machines... We Sell Solutions

Panel Lines	Ridge Cap Benders
Standing Seam Lines	Insulated Panel Lines
Control Retrofits	Portable Roll Formers
Trim Roll Formers	Hemming Roll Formers
Hydraulic Folders	Slit & Recoil Lines
Garage Door Lines	Purlin Lines

620.345.6394 www.bradburygroup.com

600 TOOLS/EQUIPMENT DISTRIBUTOR

Clark Industries, Inc.

Since 1967 - Monett, Missouri



Considering equipment?
Consider Clark.

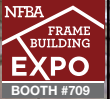

- Roof & Floor Truss Presses
- Multi-Head Truss Presses
- Modular Truss Presses
- Shuttle Presses
- Jack Presses
- H.D. Chord Splicers
- Post & Column Machines
- Floor Truss Machines
- Electric Horizontal Stackers
- Electric Peak-up Stackers
- Conveyor Systems
- Custom Machinery

Call us toll free at: 800.743.9727
or visit us on the web at: www.clark-ind.com

► NIST Joplin Tornado Study leads to code improvement

Protecting schools and their associated high-occupancy buildings from the most violent tornadoes is the goal of the first approved building code changes based on recommendations from the National Institute of Standards and Technology's technical investigation into the impacts of the deadly tornado that struck Joplin, Missouri, on May 22, 2011.

Under the updated codes, approved at a recent meeting of the International Code Council, storm shelters must be provided that protect all occupants from storms with wind speeds of 250 miles per hour, representing the maximum intensity category EF-5 on the Enhanced Fujita Scale. The area covered by the upgraded codes stretches from northern Texas to central Minnesota and from western Oklahoma to western Pennsylvania. It includes the notorious "Tornado Alley" and "Dixie Alley" regions of the midwestern and southern United States, respectively.

The improved storm shelter requirements will be published in ICC's 2018 International Building Code (IBC) and 2018 International Existing Building Code (IEBC). **RB**

► VARCO PRUDEN LANDS A SECOND TOP 10 SPOT FOR WORKPLACES

Varco Pruden Buildings was recognized a second time as a top place to work in Memphis. The Memphis Commercial Appeal ranked VP in the top 10 of Top Workplaces 2015 in the small size category (under 100 employees).

The Top Workplaces are determined based solely on employee feedback. The employee survey was conducted by WorkplaceDynamics LLC, a leading

research firm on organizational health and employee engagement. The survey criteria included topics on salary, benefits, employee engagement, and workplace environment.

Previously, Varco Pruden was recognized by the *Memphis Business Journal* as one of the Best Places to Work, as well as Mid-South's Healthiest Employers for two consecutive years. **RB**

Stabilize your building with

SHEAR-X™

Superior building strength for seismic and wind shear conditions.

This exciting new building technology is the first of its kind. Nothing else has ever provided this kind of **seismic** and **wind stability**. Shear-X allows the use of **continuous ridge vents** in **blocked** or **unblocked diaphragms**.

- For vented and non-vented hip and ridge roofs
- Provides continuous load transfer across the ridge
- Use with Shear-X RidgeVent on any type of roof: asphalt, shingle, metal or tile

For use on buildings with roof rafters 24" on center. Use on flat and pitched roofs 1:12 to 20:12. 33 mils thick ASTM-A653-SS Grade 33 Steel G90 Zinc Coating. Use .131 nails (diameter) 2.5" long (gunnable).

DrJ Technical Evaluation Report #1509-03

Garwood
MANUFACTURING CO., INC.

115 Lismore Avenue • Glenside, PA 19038

Patents Pending

Visit us at booth 727
at The Frame Building Expo



California Manufacturers Rep.

Kelly Berkompas

949.294.5428

kellyberkompas@yahoo.com

800.300.9515

The Wrinkled Series

The One Time You'll Actually WANT Wrinkles!

Want a distinguished look from every angle? Everlast Roofing can help! We are introducing a new paint finish that not only protects, it dignifies.

The *Wrinkled Series* provides you a textured paint finish that is available in Everlast's most popular profiles, making this finish an excellent choice for residential and commercial application. Request this series on top of our already proven Everlast II and Everloc panels to create a surface that is tough, scratch resistant and distinct.

Advantages Include:

- Low gloss finish
- High durability SMP
- 8 standard in-stock colors
- 35 year warranty

When you want to add character to an old or new roof ask for Wrinkles. The Wrinkled Series by Everlast Roofing Inc., Our Name Says It All!

Come shoot some hoops with us during our 3-Point Contest at the NFBA!

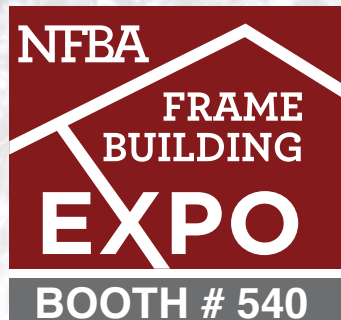

Toll Free: 888.339.0059 | www.everlastroofing.com

Circle Reader Service #407